

## CHASSIS—R.50

As produced after 1st January, 1961

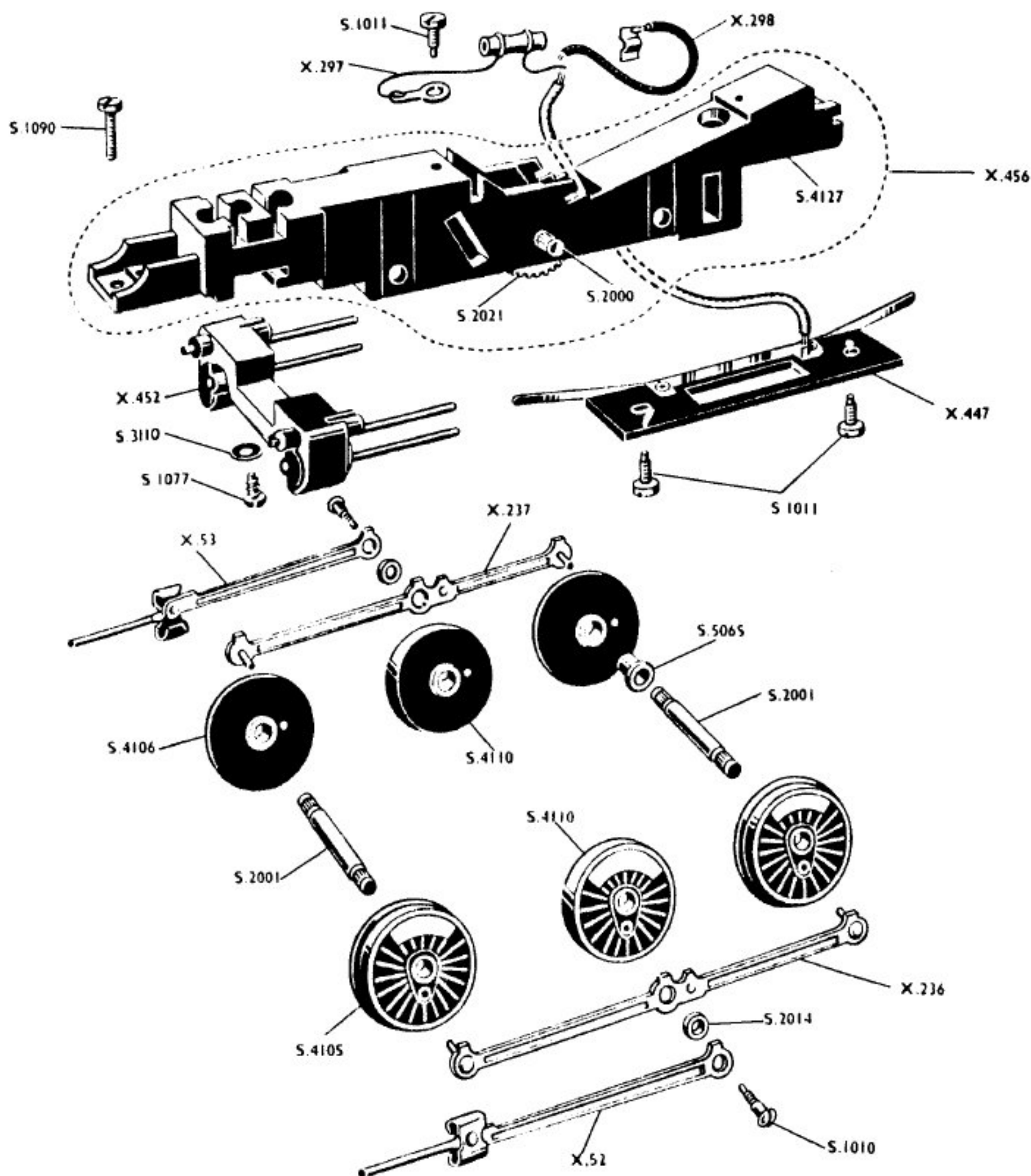

<b>X.52</b>	Crosshead Assembly (L.H)	<b>X.456</b>	Chassis Assembly (comprising S.2000, S.2021, S.4127)	<b>S.2021</b>	Worm Wheel (40 Teeth)
<b>X.53</b>	Crosshead Assembly (R.H)	<b>S.1010</b>	Coupling Rod Screw	<b>S.3110</b>	8 BA Washer
<b>X.236</b>	Coupling Rod with Pins (L.H)	<b>S.1011</b>	Standard Screw	<b>S.4105</b>	Flanged Unbushed Driving Wheel
<b>X.237</b>	Coupling Rod with Pins (R.H)	<b>S.1077</b>	Cylinder Block Securing Screw	<b>S.4106</b>	Flanged Bushed Driving Wheel
<b>X.297</b>	T.V. Suppressor and Tag Washer	<b>S.1090</b>	Body Securing Screw	<b>S.4110</b>	Flangeless Bushed Driving Wheel
<b>X.298</b>	Brush Lead and Clip	<b>S.2000</b>	Knurled Driving Axle	<b>S.4127</b>	Chassis Casting
<b>X.447</b>	Collector Assembly with Lead	<b>S.2001</b>	Plain Driving Axle	<b>S.5065</b>	Insulating Bush
<b>X.452</b>	Cylinder Block with Guide Rods	<b>S.2014</b>	Distance Piece		

For Motor and Bogies see Servicing Sheets Nos. 1 and 5b respectively.

Modifications are made to Triang Railways models from time to time. If a spare part is required which does not coincide with the illustration, a full description should be given and, if necessary, a sketch or sample should accompany the order.