

MARK 1 MOTOR — T.T. GAUGE

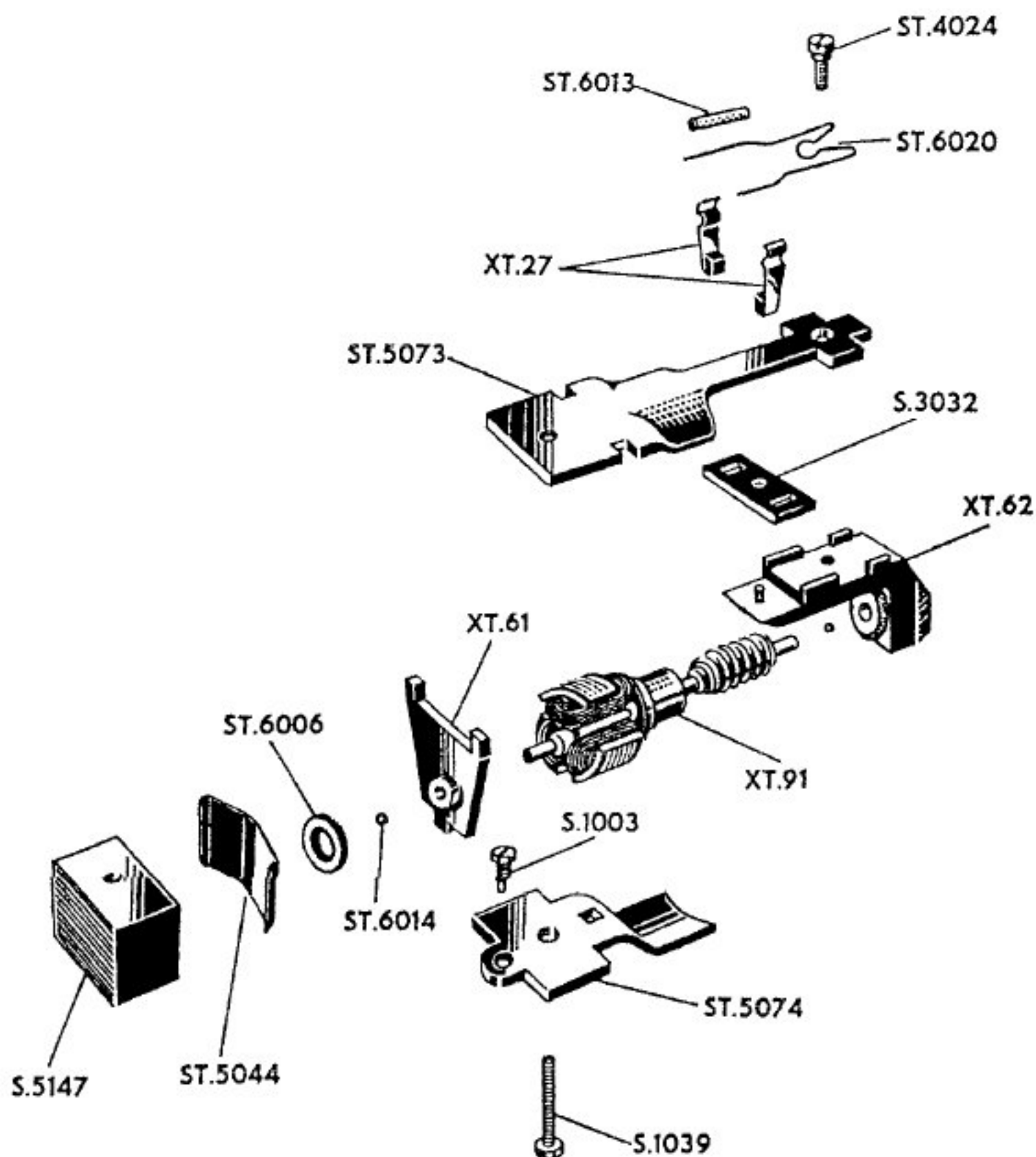

XT. 60

XT.60	Complete Motor
XT.27	Brush Arm and Brush
XT.61	Rear Bearing Plate Assembly
XT.62	Front Bearing Block Assembly
XT.91	Armature Assembly with commutator and worm
ST.4024	Brush Spring Screw
ST.5044	Rear Bearing Spring
ST.5073	Upper Pole Piece
ST.5074	Lower Pole Piece
ST.6006	Bearing Felt
ST.6013	Insulating Sleeve
ST.6014	Thrust Ball ($\frac{1}{16}$ ")
ST.6020	Brush Spring
S.1003	Motor Securing Screw
S.1039	Magnet Screw
S.3032	Brush Gear Diaphragm
S.5147	Magnet

Modifications are made to Tri-ang Railways models from time to time. If a spare part is required which does not coincide with the illustration, a full description should be given and, if necessary, a sketch or sample should accompany the order.

PRINTED IN ENGLAND



ROVEX SCALE MODELS LIMITED
WESTWOOD, MARGATE, KENT, ENGLAND
A Member of the Lines Bros. Group of Companies

SERVICING SHEET
No. 21
Issued January, 1960