

"ROCKET" LOCOMOTIVE - R.651S

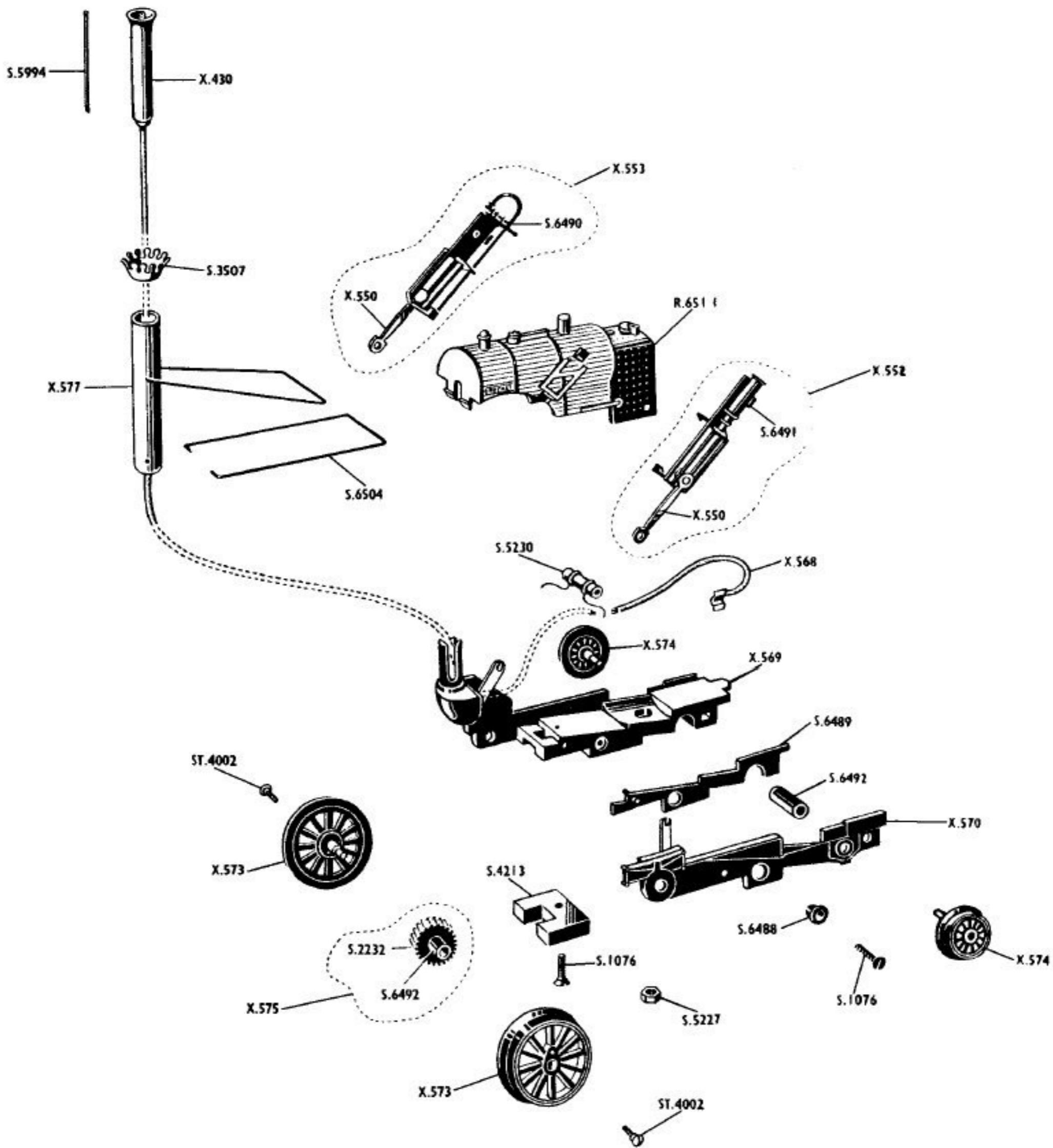

R.651 I	Body	X.573	Driving Wheel	S.5230	Capacitor
X.430	Smoke Generator with Lead (without smoke pipe)	X.574	Trailing Wheel	S.5994	Smoke Pipe
X.550	Crosshead Assembly	X.575	Worm Wheel and Axle (comprising S.2232 and S.6492)	S.6488	Insulating Bush
X.552	L/H Cylinder Assembly	X.577	Funnel and Stay	S.6489	Chassis Insulator
X.553	R/H Cylinder Assembly	S.1076	Chassis and Magnet Screw	S.6490	Cylinder R/H
X.568	Brush Lead and Clip	S.2232	Worm Wheel (26 Teeth)	S.6491	Cylinder L/H
X.569	Chassis Assembly	S.3507	Funnel Corona	S.6492	Axle
X.570	Side Frame	S.4213	Traction Magnet	S.6504	Regulator Pipe
		S.5227	Motor Securing Nut	ST.4002	Connecting Rod Screw

For Motor X.500 see Servicing Sheet No. 41

Modifications are made to Tri-ang Railways models from time to time. If a spare part is required which does not coincide with the illustration, a full description should be given and, if necessary, a sketch or sample should accompany the order.

PRINTED IN ENGLAND



ROVEX SCALE MODELS LIMITED
WESTWOOD, MARGATE, KENT, ENGLAND
A Member of the Lines Bros. Group of Companies

SERVICING SHEET
No. 40
Issued December, 1964