

LOCOMOTIVE—R.351
As produced after December, 1967

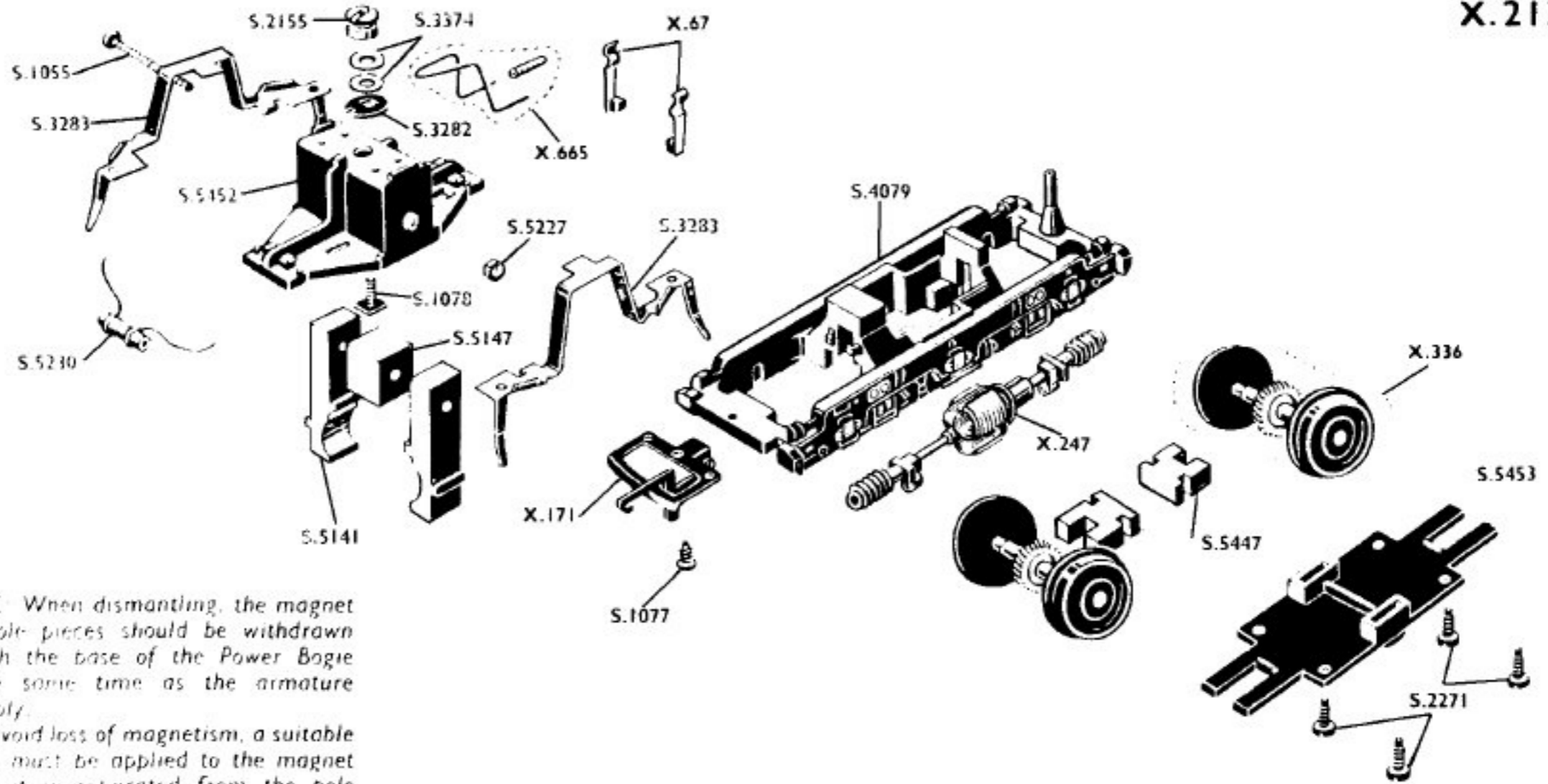
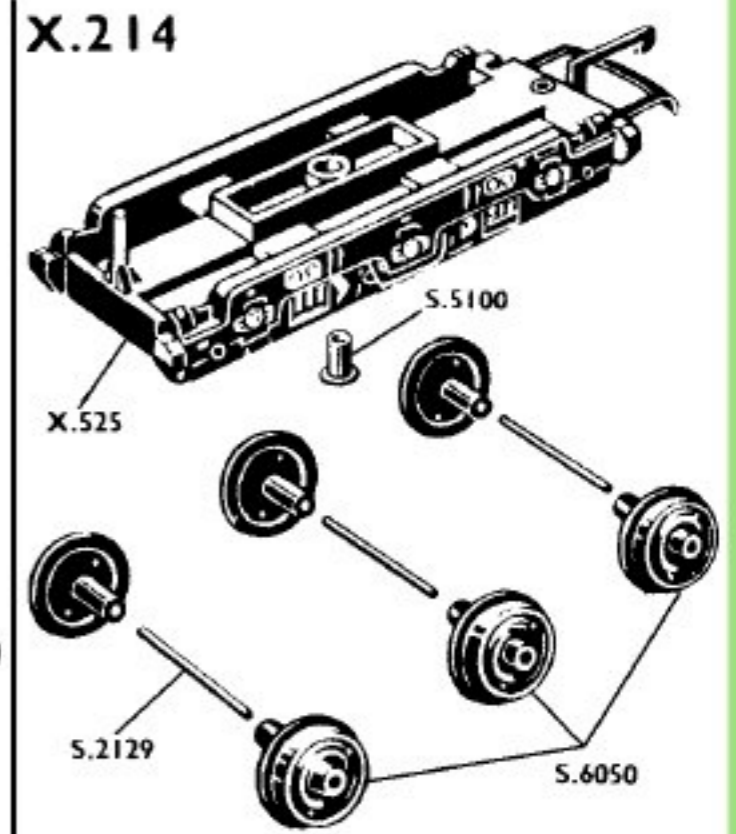
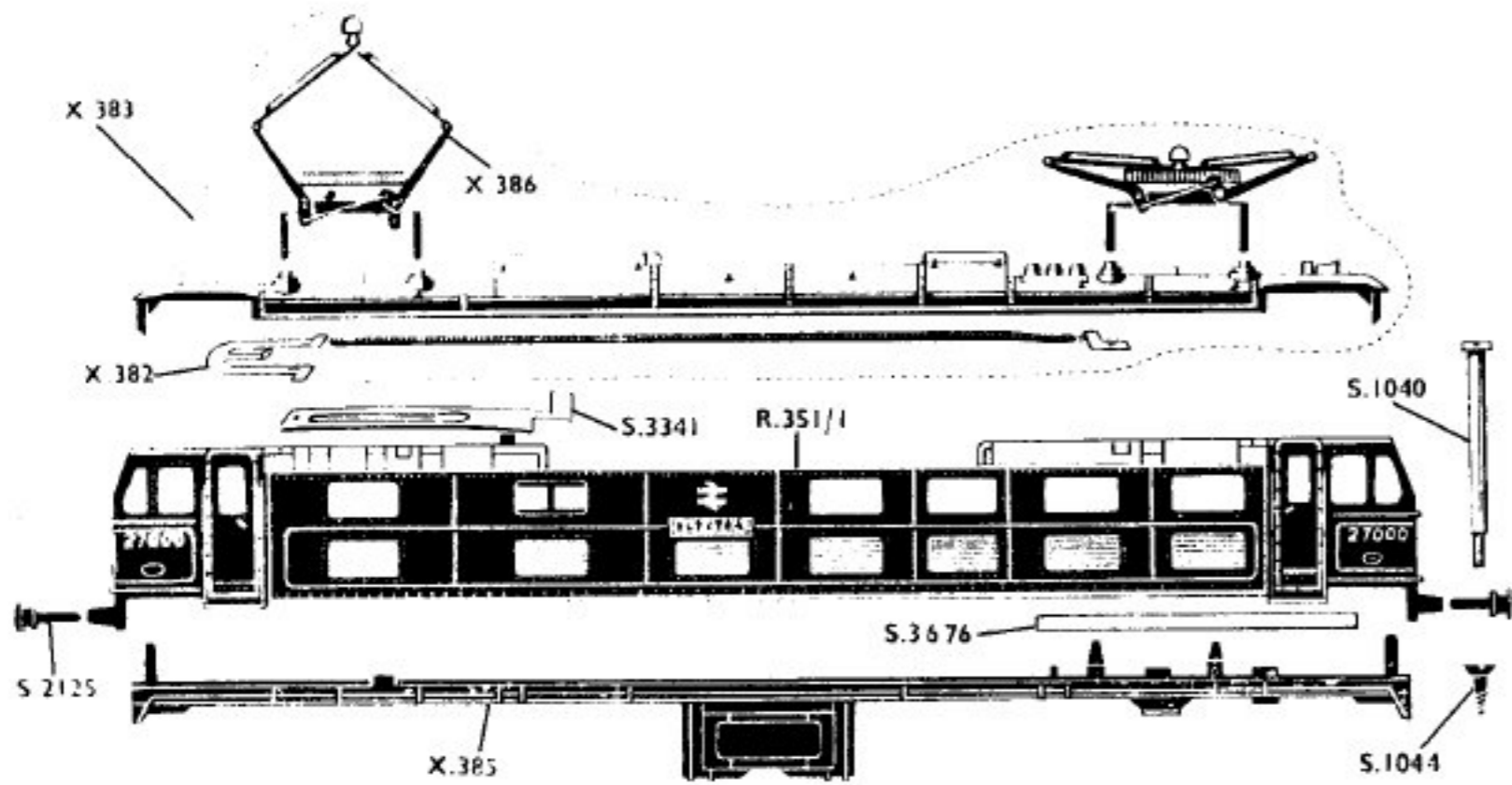

NOTE: When dismantling, the magnet and pole pieces should be withdrawn through the base of the Power Bogie at the same time as the armature assembly.
 To avoid loss of magnetism, a suitable keeper must be applied to the magnet before it is separated from the pole pieces.

- | | | |
|---|--|--------------------------------------|
| R.351 1 Body complete with windows | X.386 Pantograph | S.3341 Sliding Contact |
| X.67 Brush Arm and Brush | X.665 Brush Spring and Insulator | S.3364 6BA Washer |
| X.171 Mk. 3 Coupling Unit | S.1040 Roof Screw | S.3676 Weight |
| X.213 Power Bogie | S.1044 Weight Screw | S.4079 Power Bogie Main Frame |
| X.214 Non-powered Bogie | S.1055 Magnet Screw | S.5100 Eyelet |
| X.247 Armature Assembly | S.1077 Coupling Screw ($\frac{1}{8}$ ") | S.5141 Pole Piece |
| X.336 Axle Assembly | S.1078 Pivot Screw | S.5147 Magnet |
| X.382 Pantograph Contact, Tag and Lead | S.2106 Pivot Nut | S.5227 Magnet Screw Nut |
| X.383 Roof Assembly Complete | S.2125 Oval-headed Buffer | S.5230 Capacitor |
| X.384 Non-powered Bogie Frame Assembly | S.2129 Non-powered Bogie Axle | S.5447 Traction Magnet |
| X.385 Underframe Assembly | S.2271 Keeper Plate Screws | S.5452 Top Housing |
| | S.3282 Insulating Washer | S.5453 Keeper Plate |
| | S.3283 Collector Unit | S.6050 Wheel |

Modifications are made to Tri-ang Hornby models from time to time. If a spare part is required which does not coincide with the illustration, a full description should be given and, if necessary, a sketch or sample should accompany the order. We do not undertake to supply separate components for the parts listed with an X prefix, unless a separate S part number is shown.