

LOCOMOTIVE - R.357

As produced after December, 1967

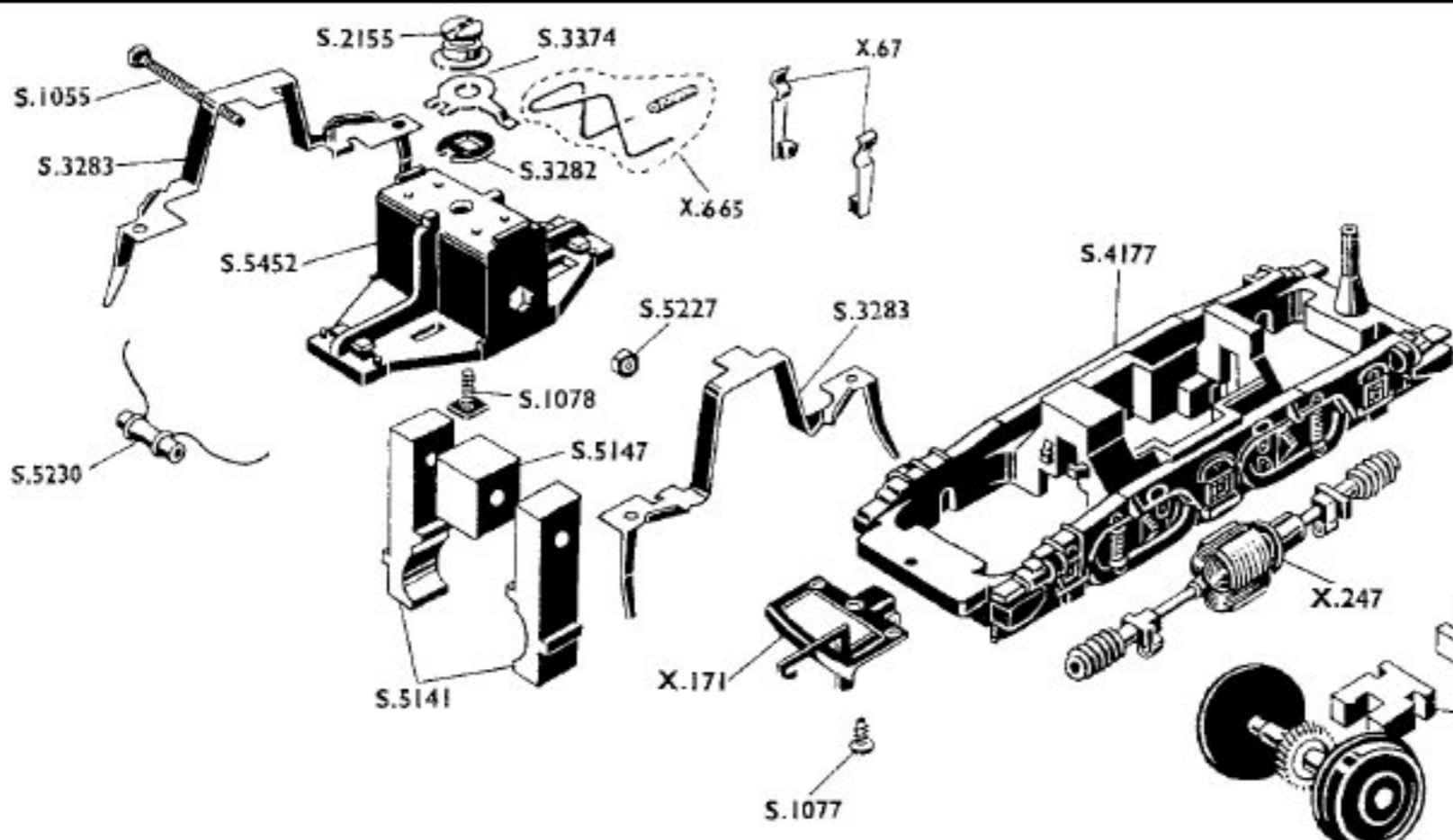
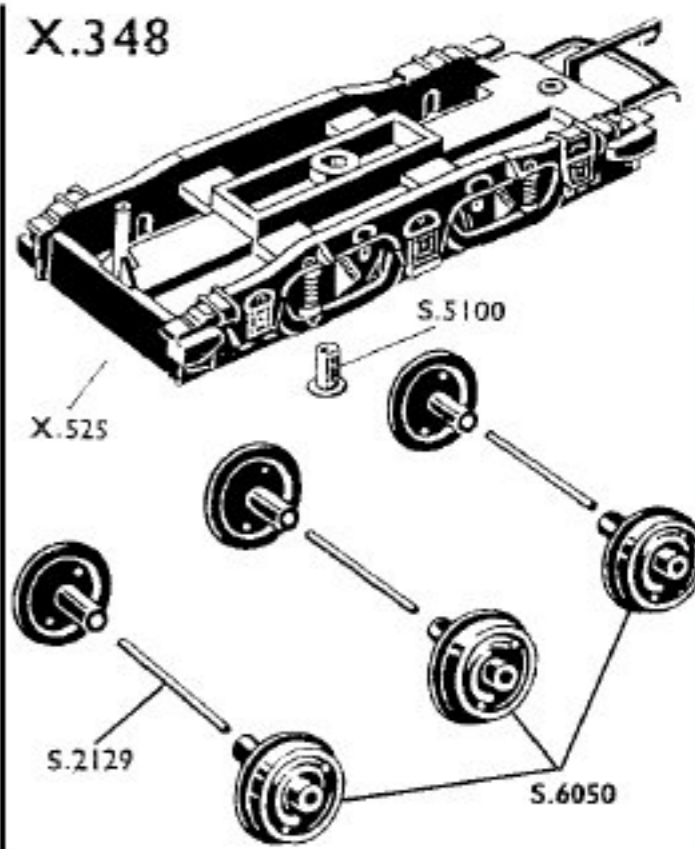
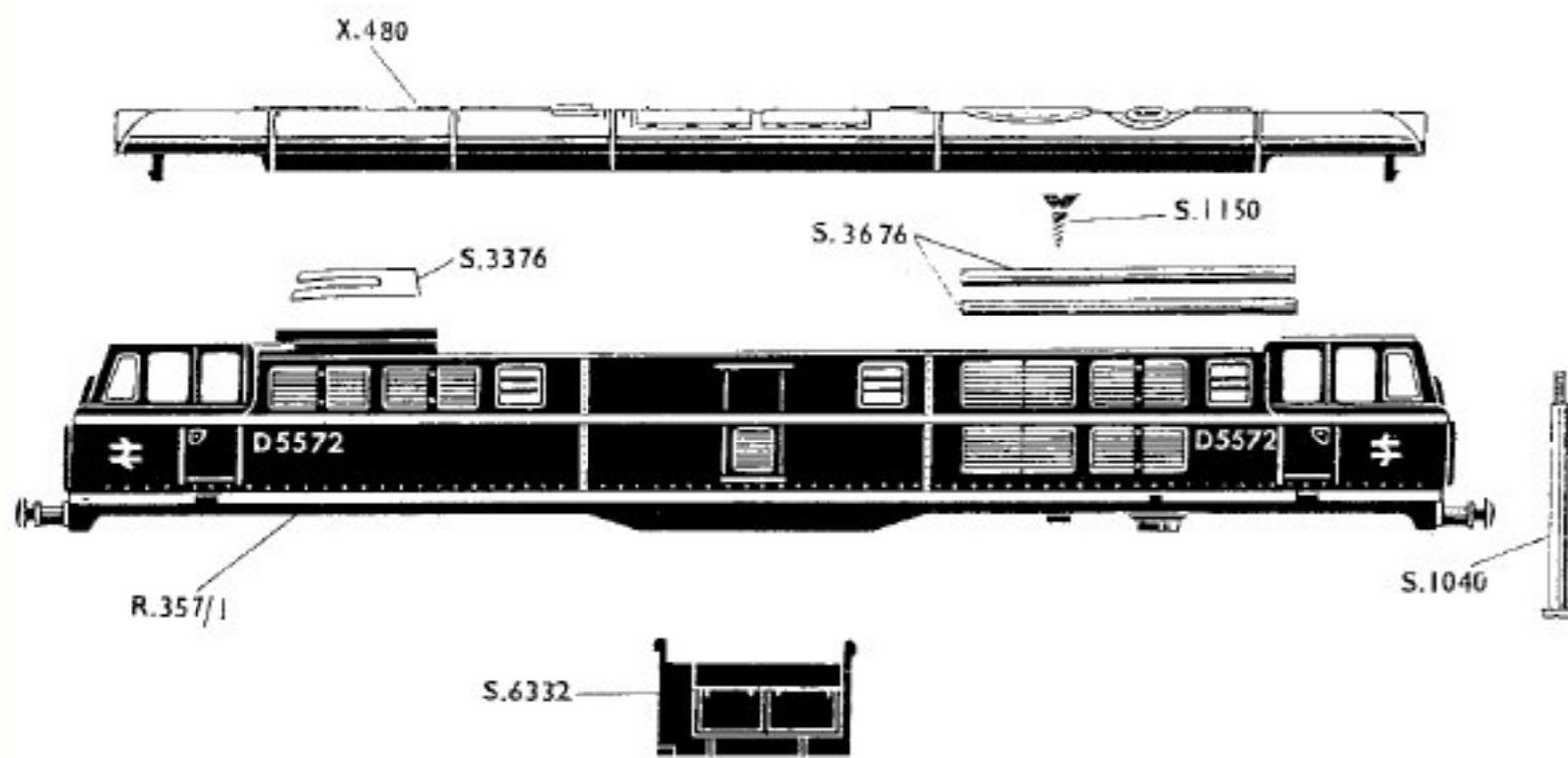

X.337
 NOTE:- When dismantling, the magnet and pole pieces should be withdrawn through the base of the power bogie at the same time as the armature assembly. To avoid loss of magnetism, a suitable keeper must be applied to the magnet before it is separated from the pole pieces.

- | | | |
|--|--|---|
| R.357/1 Body complete with Windows and Buffers | X.665 Brush Spring and Insulator | S.3376 Power Bogie Retaining Clip |
| X.67 Brush Arm and Brush | S.1040 Roof Screw | S.3676 Weight |
| X.171 Mk. 3 Coupling Unit | S.1055 Magnet Screw | S.4177 Power Bogie Main Frame |
| X.247 Armature Assembly (including Commutators, Worms and Bearings) | S.1077 Coupling Screw ($\frac{1}{8}$ ") | S.5100 Bogie Eyelet |
| X.336 Axle Assembly | S.1078 Pivot Screw | S.5141 Pole Piece |
| X.337 Power Bogie | S.1150 Weight Screw | S.5147 Magnet |
| X.348 Non-Powered Bogie | S.2129 Non-Powered Bogie Axle | S.5227 Magnet Screw Nut |
| X.480 Roof | S.2155 Pivot Nut | S.5230 Capacitor |
| X.525 Non-Powered Bogie Frame Assembly | S.2271 Keeper Plate Screw | S.5447 Traction Magnet |
| | S.3282 Insulating Washer | S.5452 Top Housing |
| | S.3283 Collector Unit | S.5453 Keeper Plate |
| | S.3374 Top Housing Contact Washer | S.6050 Wheel for Non-Powered Bogie |
| | | S.6332 Underframe |

Modifications are made to Tri-ang Hornby models from time to time. If a spare part is required which does not coincide with the illustration, a full description should be given and, if necessary, a sketch or sample should accompany the order. We do not undertake to supply separate components for the parts listed with an X prefix, unless a separate S part number is shown.

PRINTED IN ENGLAND