

LOCOMOTIVE - R.751

As produced after December, 1967

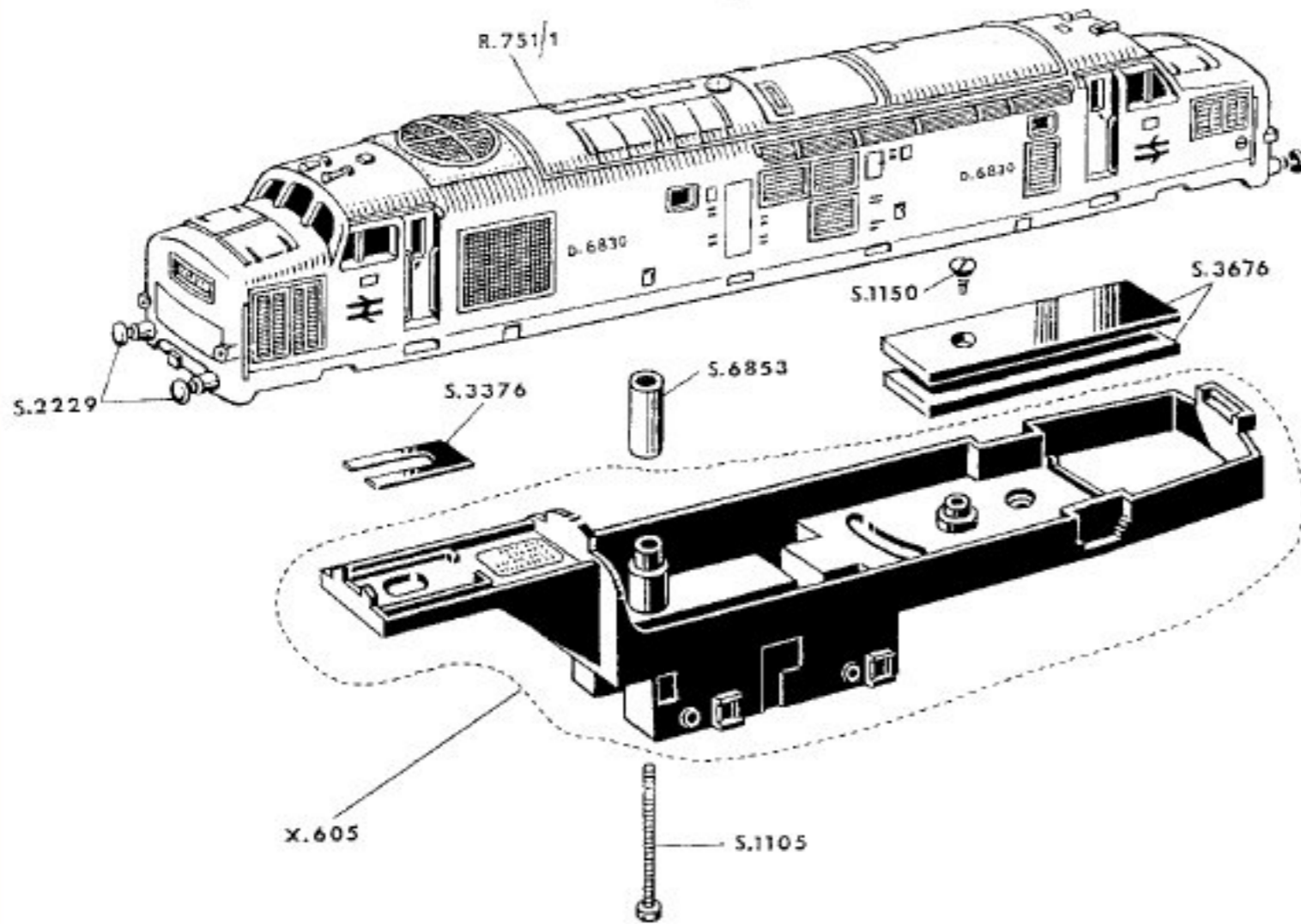

X.348

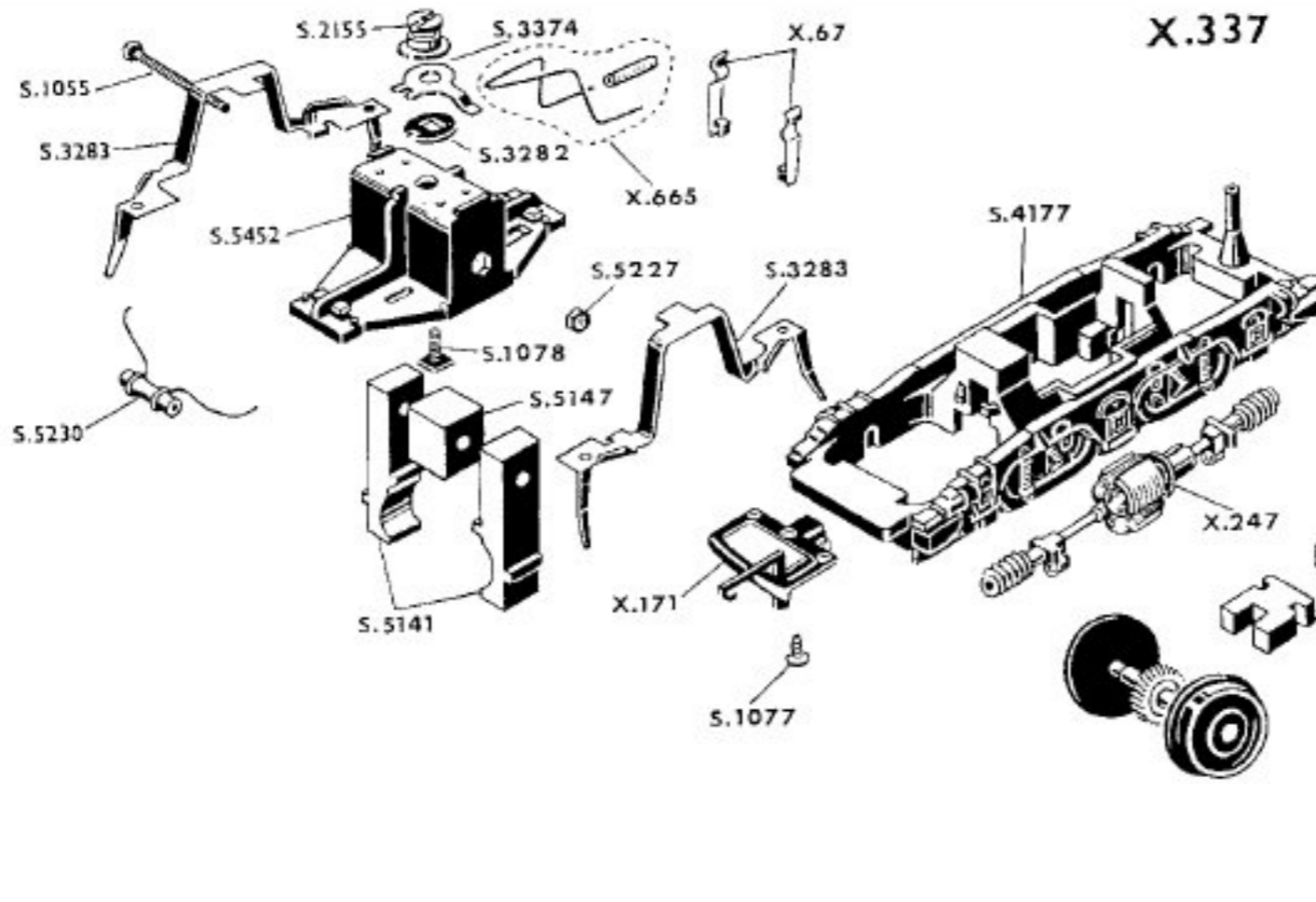
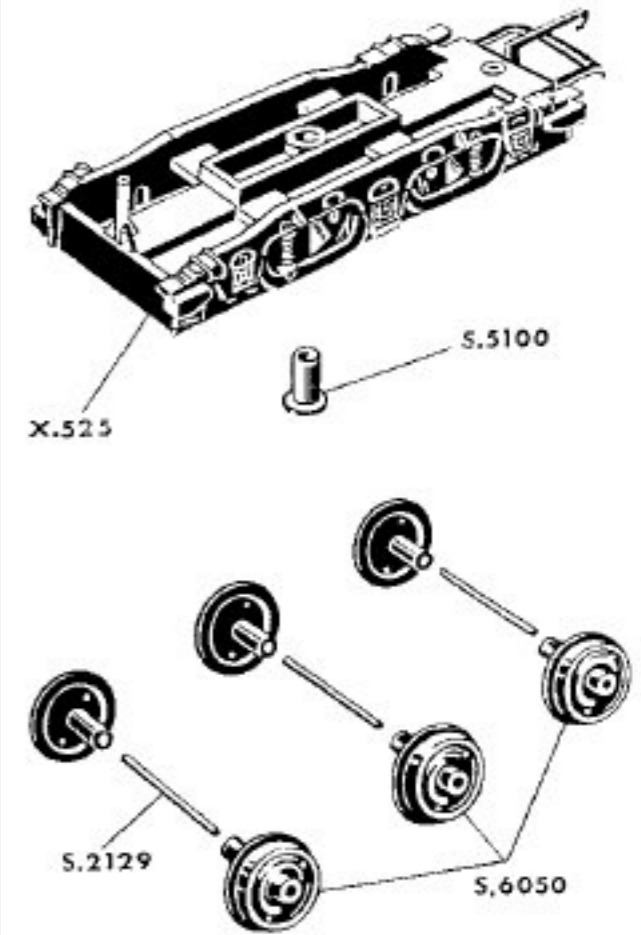

NOTE: When dismantling, the magnet and pole pieces should be withdrawn through the base of the power bogie at the same time as the armature assembly. To avoid loss of magnetism, a suitable keeper must be applied to the magnet before it is separated from the pole pieces.

- R.751/1 Locomotive Body complete with Windows, Buffers and one Route Label
- X.67 Brush Arm and Brush
- X.171 Mk. 3 Coupling Unit
- X.247 Armature Assembly (including commutator, worms and bearings)
- X.336 Axle Assembly
- X.337 Power Bogie
- X.348 Non-powered Bogie
- X.525 Non-powered Bogie Frame Assembly

- X.605 Chassis and Underframe with one Route Label
- X.665 Brush Spring and Insulator
- S.1055 Magnet Screw
- S.1077 Coupling Screw ($\frac{1}{8}$ ")
- S.1078 Pivot Screw
- S.1105 Body Securing Screw
- S.1150 Weight Screw
- S.2129 Non-powered Bogie Axle
- S.2155 Pivot Nut
- S.2229 Large Round Headed Buffer
- S.2271 Keeper Plate Screw
- S.3282 Insulating Washer
- S.3283 Collector Unit

- S.3374 Top Housing Contact Washer
- S.3376 Power Bogie Retaining Clip
- S.3676 Weight
- S.4177 Power Bogie Main Frame
- S.5100 Bogie Eyelet
- S.5141 Pole Piece
- S.5147 Magnet
- S.5227 Magnet Screw Nut
- S.5230 Capacitor
- S.5447 Traction Magnet Type B
- S.5452 Top Housing
- S.5453 Keeper Plate
- S.6050 Wheel for Non-powered Bogie
- S.6853 Distance Piece

Modifications are made to Tri-ang Hornby models from time to time. If a spare part is required which does not coincide with the illustration, a full description should be given and, if necessary, a sketch or sample should accompany the order. We do not undertake to supply separate components for the parts listed with an X prefix, unless a separate S part number is shown.