

# LOCOMOTIVE—RV.272

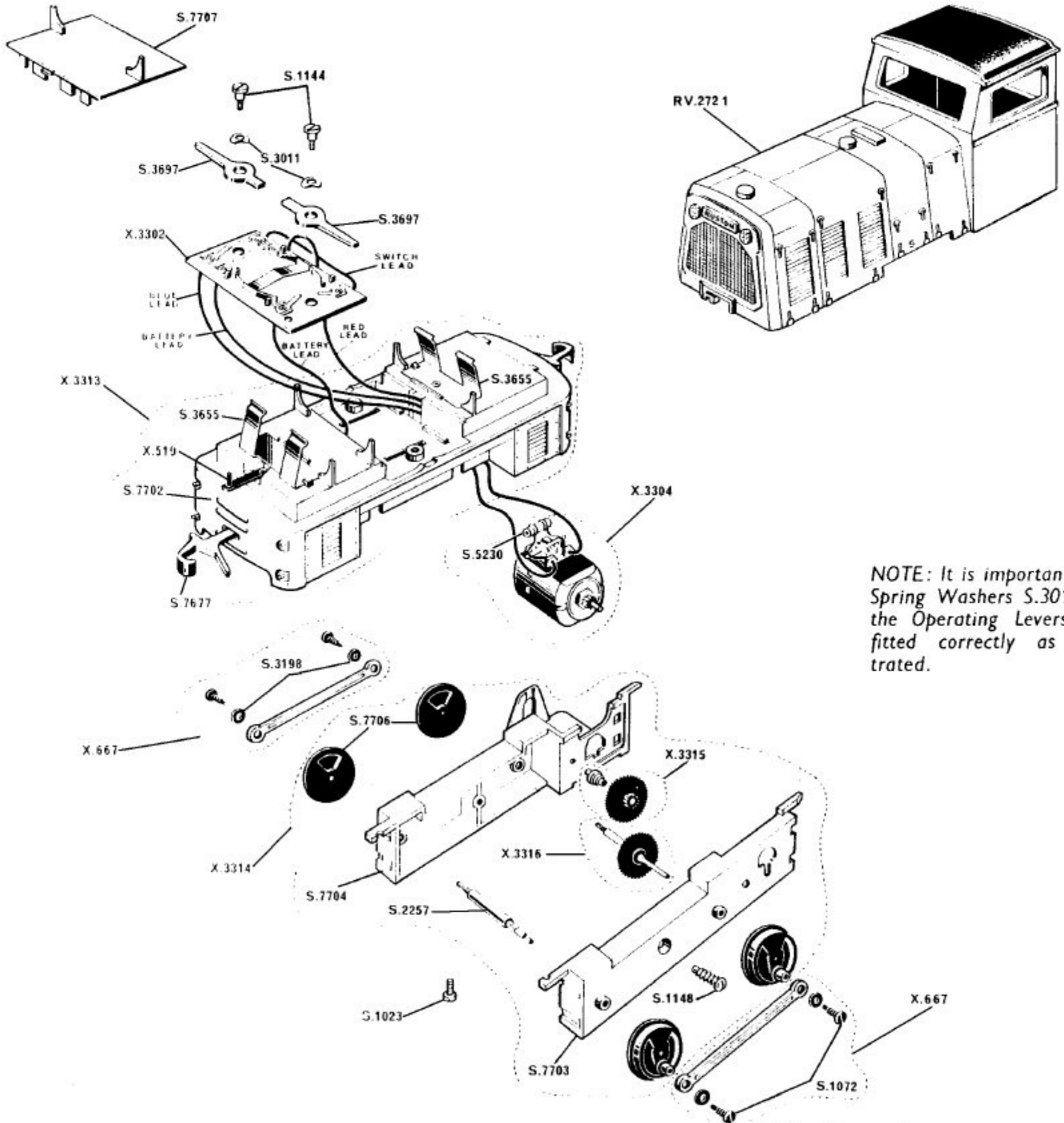

**NOTE:** It is important that Spring Washers S.3011 for the Operating Levers are fitted correctly as illustrated.

- |  |   |                                 |
|--|---|---------------------------------|
| <b>RV.272</b>   Locomotive Body                                  | <b>X.3315</b>   Gear and Pinion             | <b>S.3655</b>   Battery Clip    |
| <b>X.519</b>   Drawbar (Body Securing)                           | <b>X.3316</b>   Driving Axle and Gear       | <b>S.3697</b>   Operating Lever |
| <b>X.667</b>   L H and R/H Coupling Rods with Screws and Washers | <b>S.1023</b>   Chassis and Footplate Screw | <b>S.5230</b>   Capacitor       |
| <b>X.3302</b>   Switch Panel Assembly                            | <b>S.1072</b>   Coupling Rod Screw          | <b>S.7677</b>   Coupling        |
| <b>X.3304</b>   Motor Assembly                                   | <b>S.1144</b>   Switch Securing Screw       | <b>S.7702</b>   Footplate       |
| <b>X.3313</b>   Footplate Assembly                               | <b>S.1148</b>   Chassis Assembly Screw      | <b>S.7703</b>   Gearbox Cover   |
| <b>X.3314</b>   Chassis Assembly complete with Wheels            | <b>S.2257</b>   Axle                        | <b>S.7704</b>   Motor Housing   |
|  | <b>S.3011</b>   Spring Washer               | <b>S.7706</b>   Wheel           |
|  | <b>S.3198</b>   Coupling Rod Washer         | <b>S.7707</b>   Cover Plate     |

*Modifications are made to Tri-ang models from time to time. If a spare part is required which does not coincide with the illustration, a full description should be given and, if necessary, a sketch or sample should accompany the order. We do not undertake to supply separate components for the parts listed with an X prefix, unless a separate S part number is shown.*