

LOCOMOTIVE - R.758

As produced after December, 1967

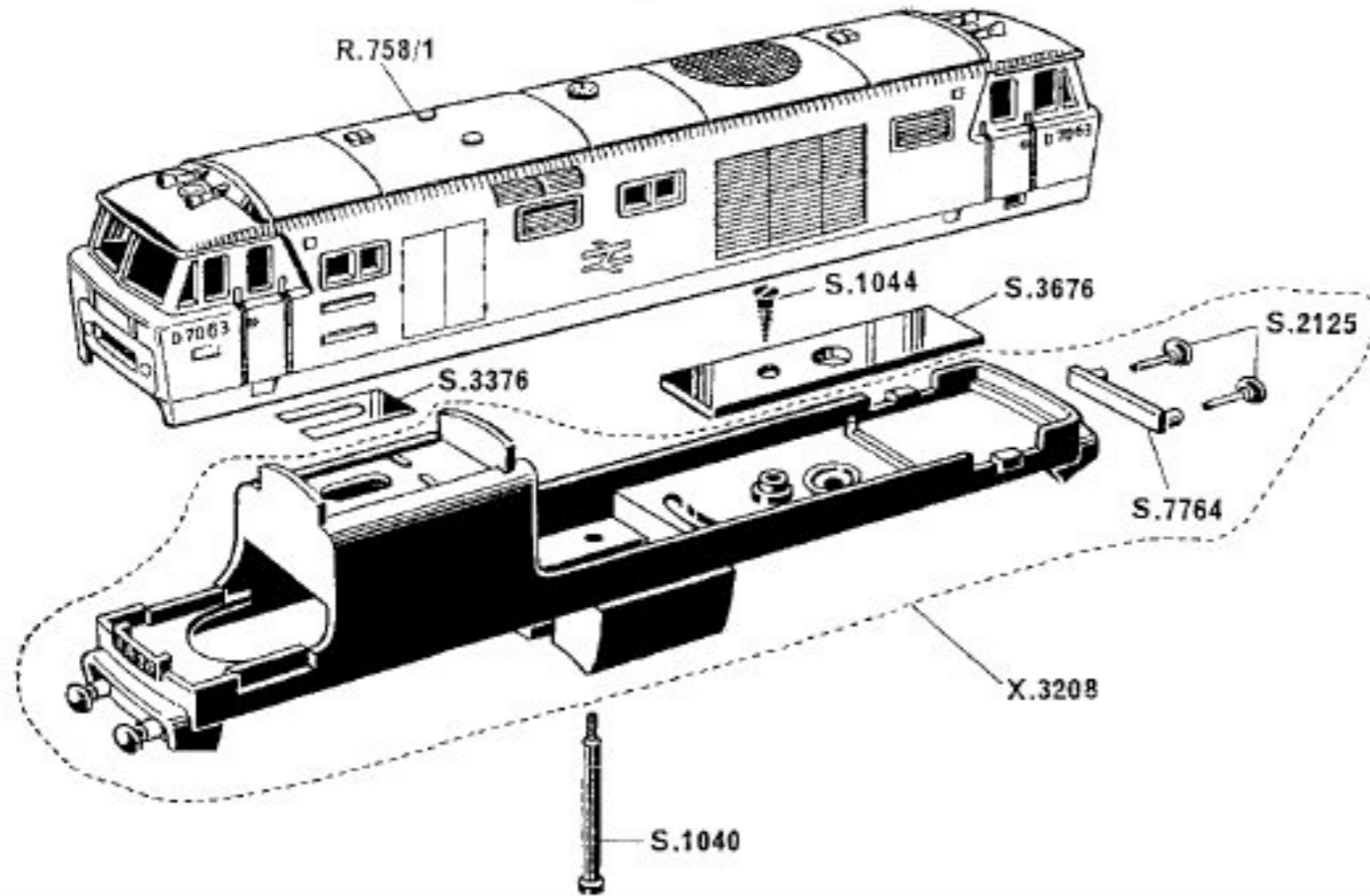

X.620

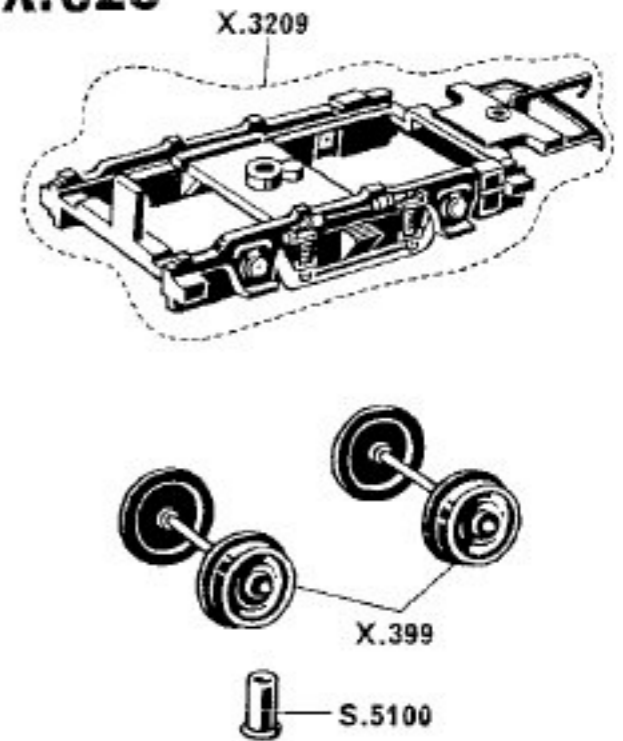

X.3170

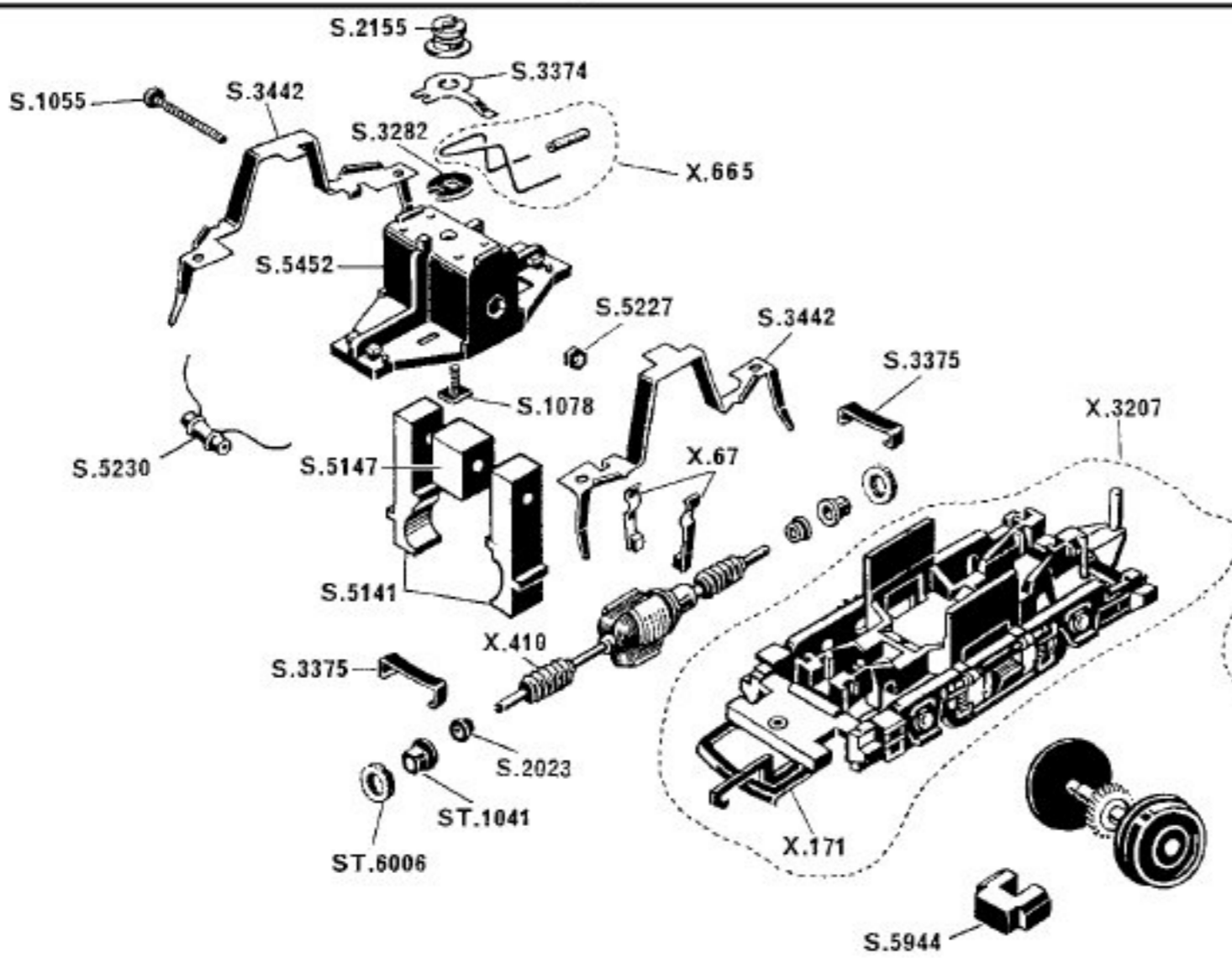

NOTE: To avoid loss of magnetism when dismantling, a suitable keeper must be applied to the magnet.

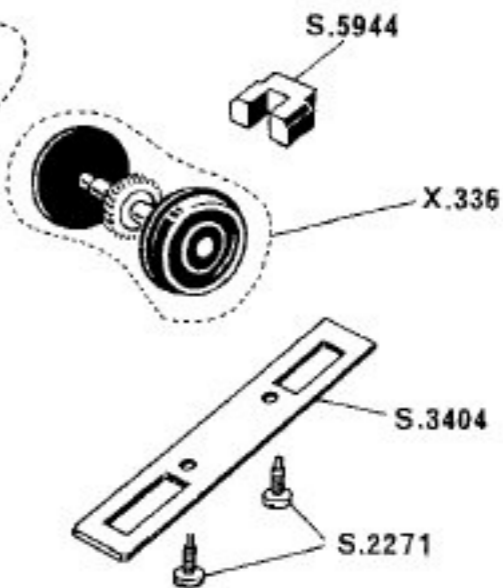

- R.758/1** Body complete with Windows and one Route Label
- X.67** Brush Arm and Brush
- X.171** Mk. 3 Coupling Unit
- X.336** Axle Assembly (Power Bogie)
- X.399** Axle Assembly
- X.410** Armature Assembly (including commutator and worms)
- X.620** Non-powered Bogie
- X.665** Brush Spring and Insulator
- X.3170** Power Bogie
- X.3207** Power Bogie Frame Assembly
- X.3208** Underframe Assembly

- X.3209** Non-powered Bogie Frame Assembly
- S.1040** Body Screw
- S.1044** Weight Screw
- S.1055** Magnet Screw
- S.1078** Pivot Screw
- S.2023** Thrust Bush
- S.2125** Buffer (Oval Headed)
- S.2155** Pivot Nut
- S.2271** Keeper Plate Screw
- S.3282** Insulating Washer
- S.3374** Top Housing Contact Washer
- S.3375** Bearing Clip

- S.3376** Power Bogie Retaining Clip
- S.3404** Keeper Plate
- S.3442** Collector Unit
- S.3676** Weight
- S.5100** Eyelet
- S.5141** Pole Piece
- S.5147** Magnet
- S.5227** 8BA Nut
- S.5230** Capacitor
- S.5452** Top Housing
- S.5944** Traction Magnet
- ST.1041** Bearing Bush
- ST.6006** Bearing Felt

Modifications are made to Tri-ang Hornby models from time to time. If a spare part is required which does not coincide with the illustration, a full description should be given and, if necessary, a sketch or sample should accompany the order. We do not undertake to supply separate components for the parts listed with an X prefix, unless a separate S part number is shown.