

O-4-0 LOCOMOTIVE CHASSIS - R.455, R.755

Most parts also applicable to R.355

As shown below uses X.04 Motor
See Service Sheet No. 81

Alternative version using X.842 Motor

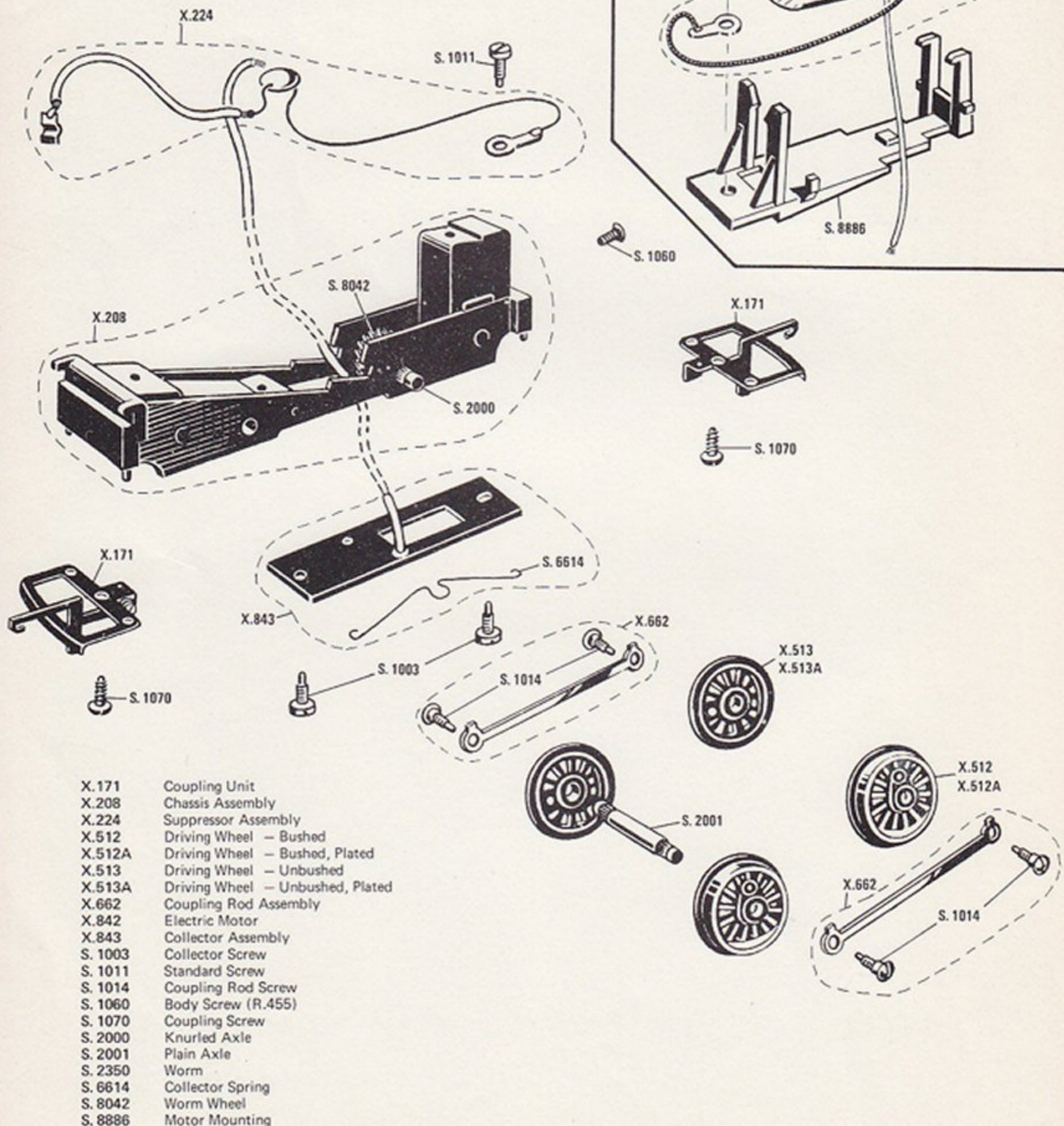

- | | |
|--------|----------------------------------|
| X.171 | Coupling Unit |
| X.208 | Chassis Assembly |
| X.224 | Suppressor Assembly |
| X.512 | Driving Wheel - Bushed |
| X.512A | Driving Wheel - Bushed, Plated |
| X.513 | Driving Wheel - Unbushed |
| X.513A | Driving Wheel - Unbushed, Plated |
| X.662 | Coupling Rod Assembly |
| X.842 | Electric Motor |
| X.843 | Collector Assembly |
| S.1003 | Collector Screw |
| S.1011 | Standard Screw |
| S.1014 | Coupling Rod Screw |
| S.1060 | Body Screw (R.455) |
| S.1070 | Coupling Screw |
| S.2000 | Knurled Axle |
| S.2001 | Plain Axle |
| S.2350 | Worm |
| S.6614 | Collector Spring |
| S.8042 | Worm Wheel |
| S.8886 | Motor Mounting |

Modifications are made to models from time to time. If a spare part is required which does not coincide with the illustration, a full description should be given and, if necessary, a sketch or sample should accompany the order.