

4-6-0 G.W.R. HALL CLASS LOCOMOTIVE—R.313 "Hagley Hall"

Most parts also suitable for R.759, R.761 & R.765

For X.03 Motor see Service Sheet No. 81B

Magnadhesion is fitted to this model.

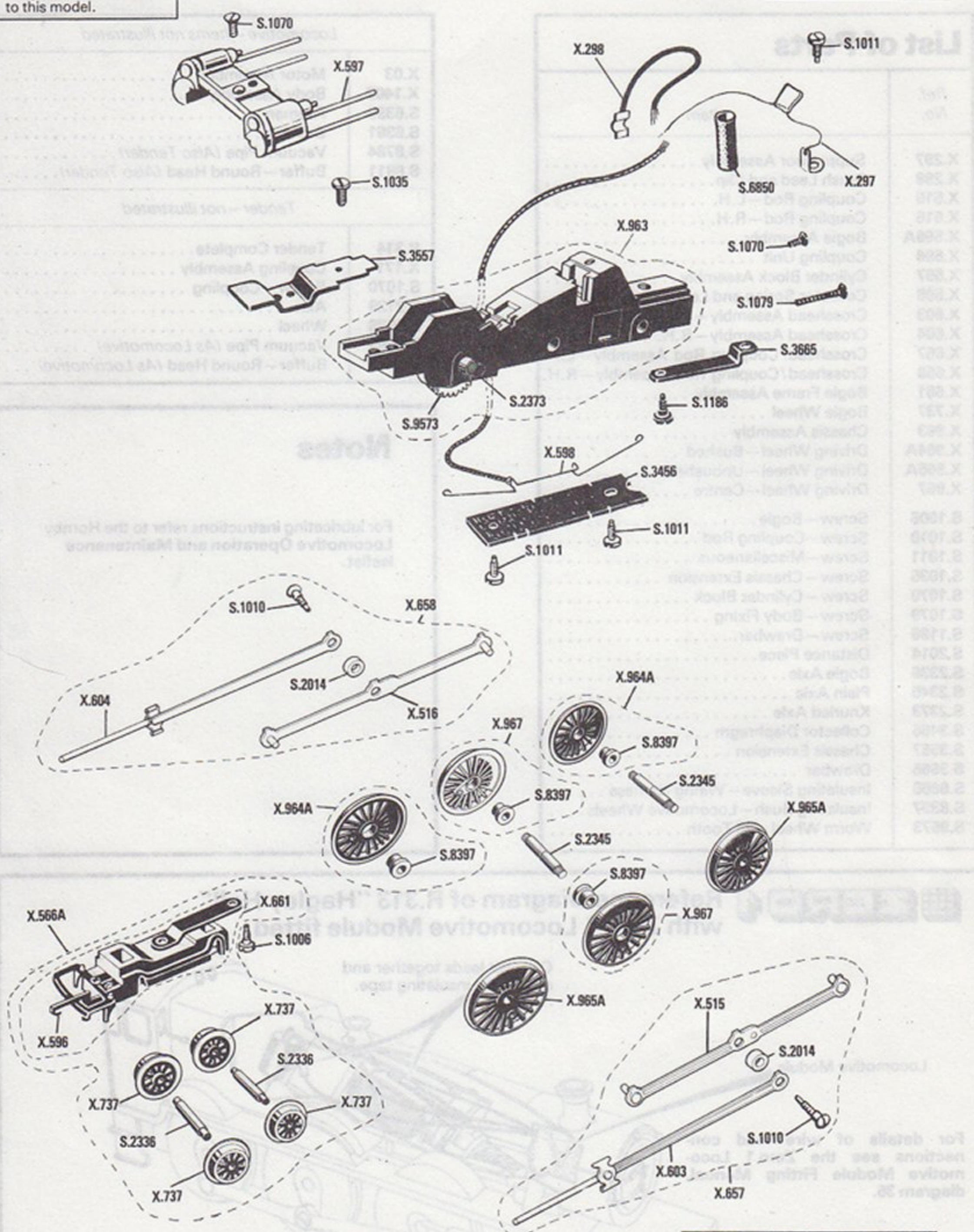

ROVEX Service Centre

Albert Street, Ramsgate, Kent, CT11 9HD, England.

SERVICE SHEET No. 86B

Issued August 1980
Supersedes Sheet No. 86A

4-6-0 G.W.R. HALL CLASS LOCOMOTIVE—R.313 "Hagley Hall"

Most parts also suitable for R.759, R.761 & R.765

List of Parts

Ref. No.	Item
X.297	Suppressor Assembly
X.298	Brush Lead and Clip
X.515	Coupling Rod—L.H.
X.516	Coupling Rod—R.H.
X.566A	Bogie Assembly
X.596	Coupling Unit
X.597	Cylinder Block Assembly
X.598	Collector Spring and Lead
X.603	Crosshead Assembly—L.H.
X.604	Crosshead Assembly—R.H.
X.657	Crosshead/Coupling Rod Assembly—L.H.
X.658	Crosshead/Coupling Rod Assembly—R.H.
X.661	Bogie Frame Assembly
X.737	Bogie Wheel
X.963	Chassis Assembly
X.964A	Driving Wheel—Bushed
X.965A	Driving Wheel—Unbushd
X.967	Driving Wheel—Centre
S.1006	Screw—Bogie
S.1010	Screw—Coupling Rod
S.1011	Screw—Miscellaneous
S.1035	Screw—Chassis Extension
S.1070	Screw—Cylinder Block
S.1079	Screw—Body Fixing
S.1186	Screw—Drawbar
S.2014	Distance Piece
S.2336	Bogie Axle
S.2345	Plain Axle
S.2373	Knurled Axle
S.3456	Collector Diaphragm
S.3557	Chassis Extension
S.3665	Drawbar
S.6850	Insulating Sleeve—Wiring Harness
S.8397	Insulating Bush—Locomotive Wheels
S.9573	Worm Wheel—28 Tooth

Locomotive—Items not illustrated	
X.03	Motor Assembly
X.1407	Body Assembly
S.6390	Fireman
S.6391	Driver
S.8784	Vacuum Pipe (Also Tender)
S.8911	Buffer—Round Head (Also Tender)

Tender—not illustrated	
R.314	Tender Complete
X.171	Coupling Assembly
S.1070	Screw—Coupling
S.2129	Axle
S.5938	Wheel
S.8784	Vacuum Pipe (As Locomotive)
S.8911	Buffer—Round Head (As Locomotive)

Notes

For lubricating instructions refer to the Hornby Locomotive Operation and Maintenance leaflet.



Reference Diagram of R.313 "Hagley Hall" with Zero 1 Locomotive Module fitted.

