

GWR 4-6-0 LOCOMOTIVE "KING" CLASS

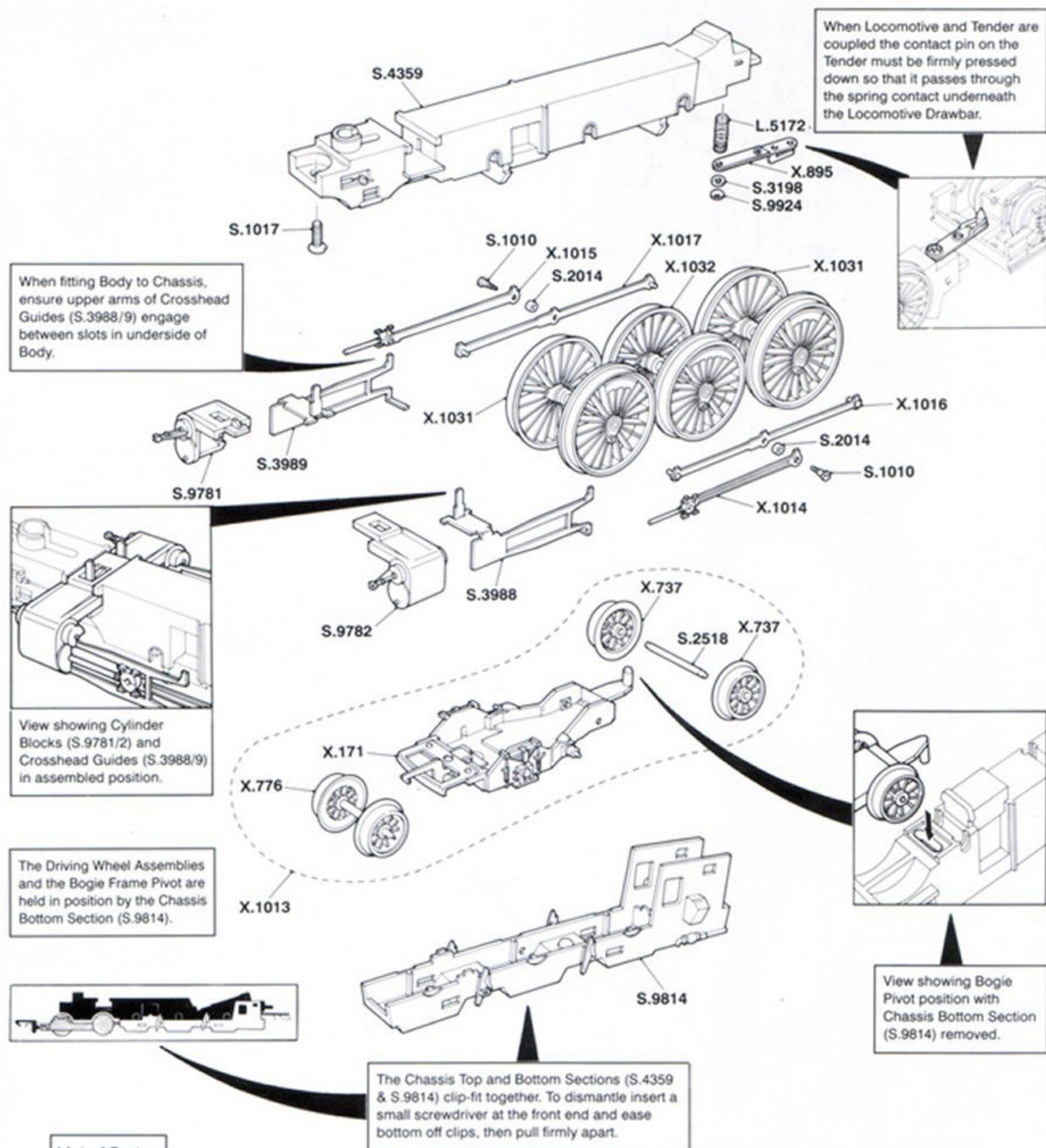

List of Parts

Ref. No.	Item	Ref. No.	Item	Ref. No.	Item
X.171	Coupling Unit Assembly	X.1031	Driving Wheel / Axle Assembly ...	S.4359	Chassis - Top Section
X.737	Wheel Assembly - Bogie	X.1032	Driving Wheel / Axle Assembly - Centre	S.9781	Cylinder Block - R.H.
X.776	Wheel / Axle Assembly - Bogie			S.9782	Cylinder Block - L.H.
X.895	Drawbar Assembly			S.9814	Chassis - Bottom Section
X.1013	Bogie Assembly Complete	S.1010	Screw - Coupling Rod	S.9924	Retaining Clip - Drawbar
X.1014	Connecting Rod / Piston Assembly - L.H.	S.1017	Screw - Body Fixing	Not Illustrated	
		S.2014	Distance Piece	S.2345	Axle - Driving Wheel
X.1015	Connecting Rod / Piston Assembly - R.H.	S.2518	Axle - Bogie	S.2382	Axle Bearing
		S.3198	Washer - Drawbar	S.8397	Insulating Bush
X.1016	Coupling Rod - L.H.	S.3988	Crosshead Guide - L.H.	L.5172	Spring
X.1017	Coupling Rod - R.H.	S.3989	Crosshead Guide - R.H.		

TENDER DRIVE FOR GWR LOCOMOTIVE "KING" CLASS

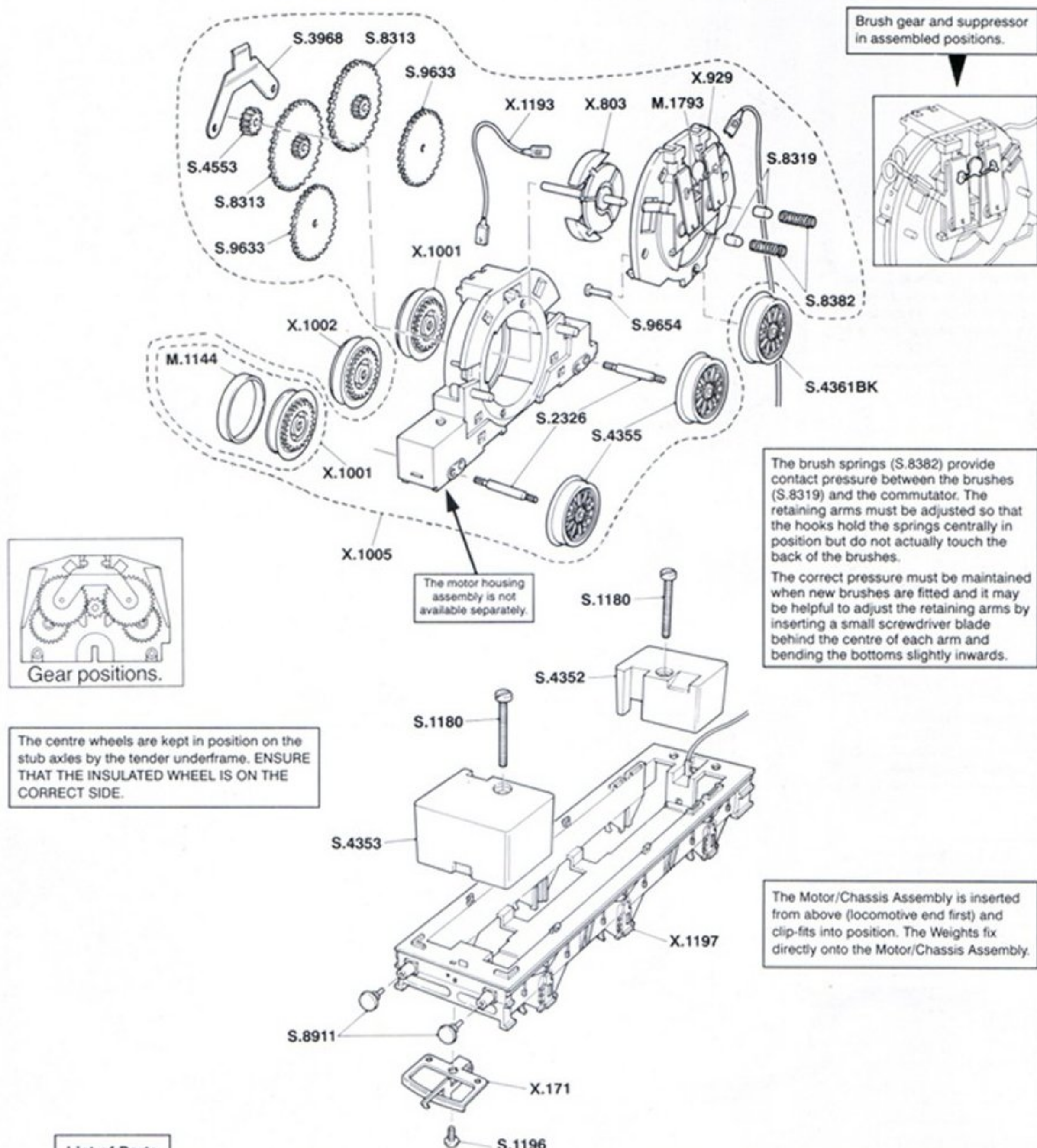

List of Parts

Ref. No.	Item	Ref. No.	Item	Ref. No.	Item
X.171	Coupling Unit Assembly	M.1144	Traction Tyre	S.4355	Driving Wheel - Metal
X.803	Armature Assembly	M.1793	Suppressor	S.4361BK	Centre Wheel - Metal
X.929	Brush Retaining Arm Assembly			S.4553	Spur Gear - 11 Tooth
X.1001	Driving Wheel - Tyre	S.1180	Screw - Weight Fixing	S.5313	Spur Gear - 40/10 Tooth
X.1002	Driving Wheel - Centre	S.1196	Screw - Coupling Unit Assembly	S.8319	Carbon Brush
X.1005	Motor / Chassis Assembly	S.2326	Axle	S.8382	Brush Spring
X.1193	Wire Lead Assembly	S.3968	Gear Retainer	S.8911	Buffer - Round Head
X.1197	Tender Chassis Assembly	S.4352	Weight - Front	S.9633	Spur Gear - 33 Tooth
		S.4353	Weight - Rear	S.9654	Stub Axle