

0 - 4 - 0 LOCOMOTIVE CHASSIS - R.077

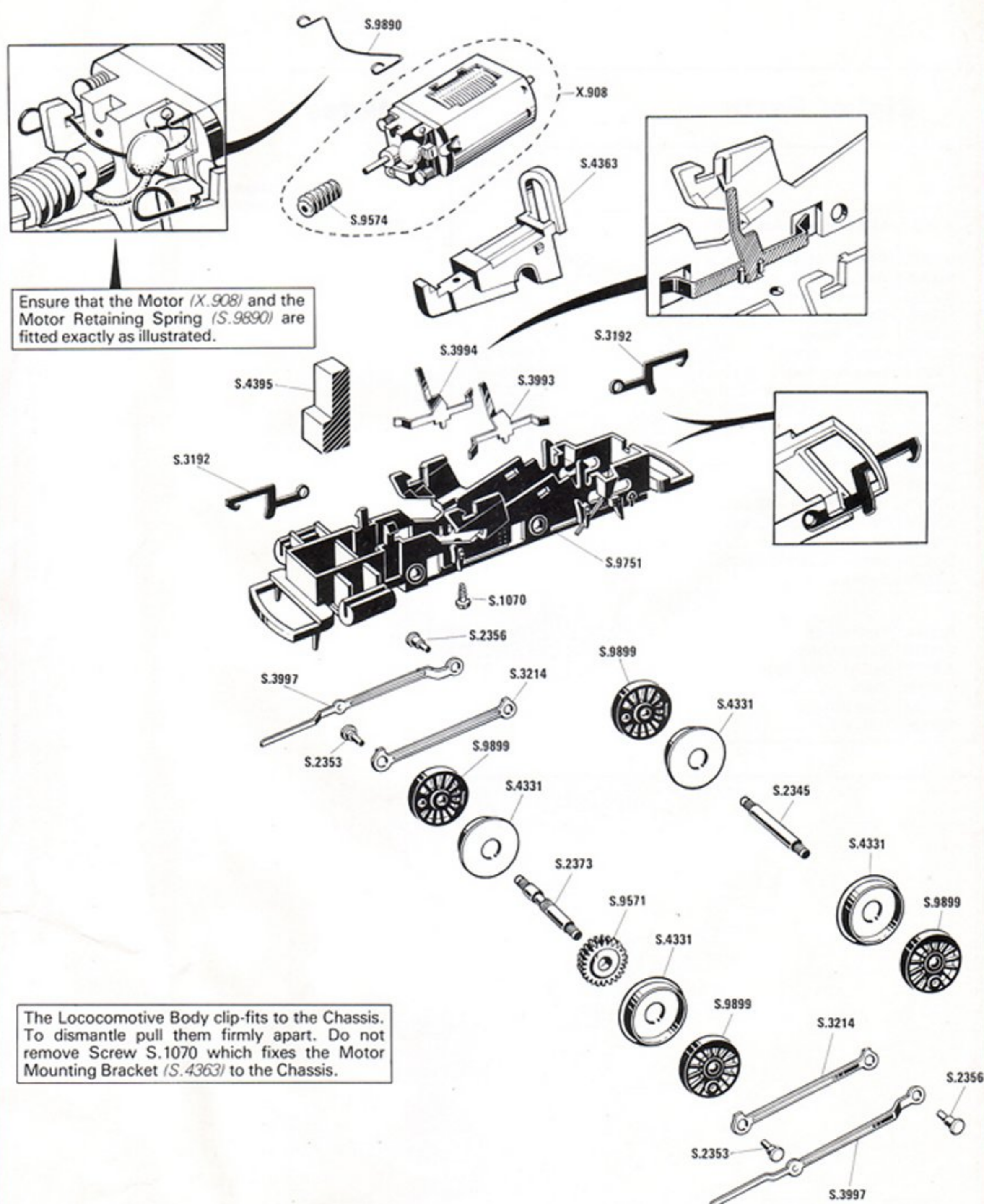

Modifications are made to models from time to time. If a spare part is required which does not coincide with the illustration, a full description should be given and, if necessary, a sketch or sample should accompany the order.

ROVEX Service Centre

Albert Street, Ramsgate,
Kent, CT11 9HD, England.

SERVICE SHEET No.115

Issued September 1977

HORNBY RAILWAYS

0 - 4 - 0 LOCOMOTIVE CHASSIS - R.077

List of Parts

Cat. No.	Item	For Rovex internal use only
X.908	Motor/Worm Assembly	
S.1070	Screw—Motor Mounting Bracket	Z100-0300
S.2345	Axle—Rear	R859-0760
S.2353	Coupling Rod Pin—Front	R254-0700
S.2356	Coupling Rod Pin—Rear	R254-0710
S.2373	Axle—Front	R255-0700
S.3192	Coupling Hook	R009-0311
S.3214	Coupling Rod	R455-0310
S.3993	Current Collector—L.H.	R077-0460
S.3994	Current Collector—R.H.	R077-0470
S.3997	Connecting Rod/Piston	R077-0310
S.4331	Metal Tyre	R254-0560
S.4363	Motor Mounting Bracket	R077-0560
S.4395	Weight	R077-0570
S.9571	Worm Wheel—18 Tooth	R255-0010
S.9574	Worm—Single Thread	R254-0660
S.9751	Chassis	R077-0050
S.9890	Motor Retaining Spring	R077-0700
S.9899	Spoke Insert	R077-0040
<i>Items not illustrated</i>		
S.2140	Funnel Cap	R041-0680
S.2219	Safety Valve	R759-0670
S.8911	Buffer—Round Head	R041-0070
S.9786	Body	R077-0010
S.9787	Coal Hopper	R077-0020
S.9788	Coal Insert	R077-0030

Notes

For lubricating instructions refer to the Hornby Locomotive Operation and Maintenance leaflet.

ROVEX Service Centre

ALBERT STREET, RAMSGATE,
KENT, CT11 9HD, ENGLAND.