

**4-6-2 LOCOMOTIVE CLASS A4**

Locomotives of this class modelled by Hornby: Mallard, Silver Fox, Silver Link, Golden Eagle, Seagull, Sir Nigel Gresley

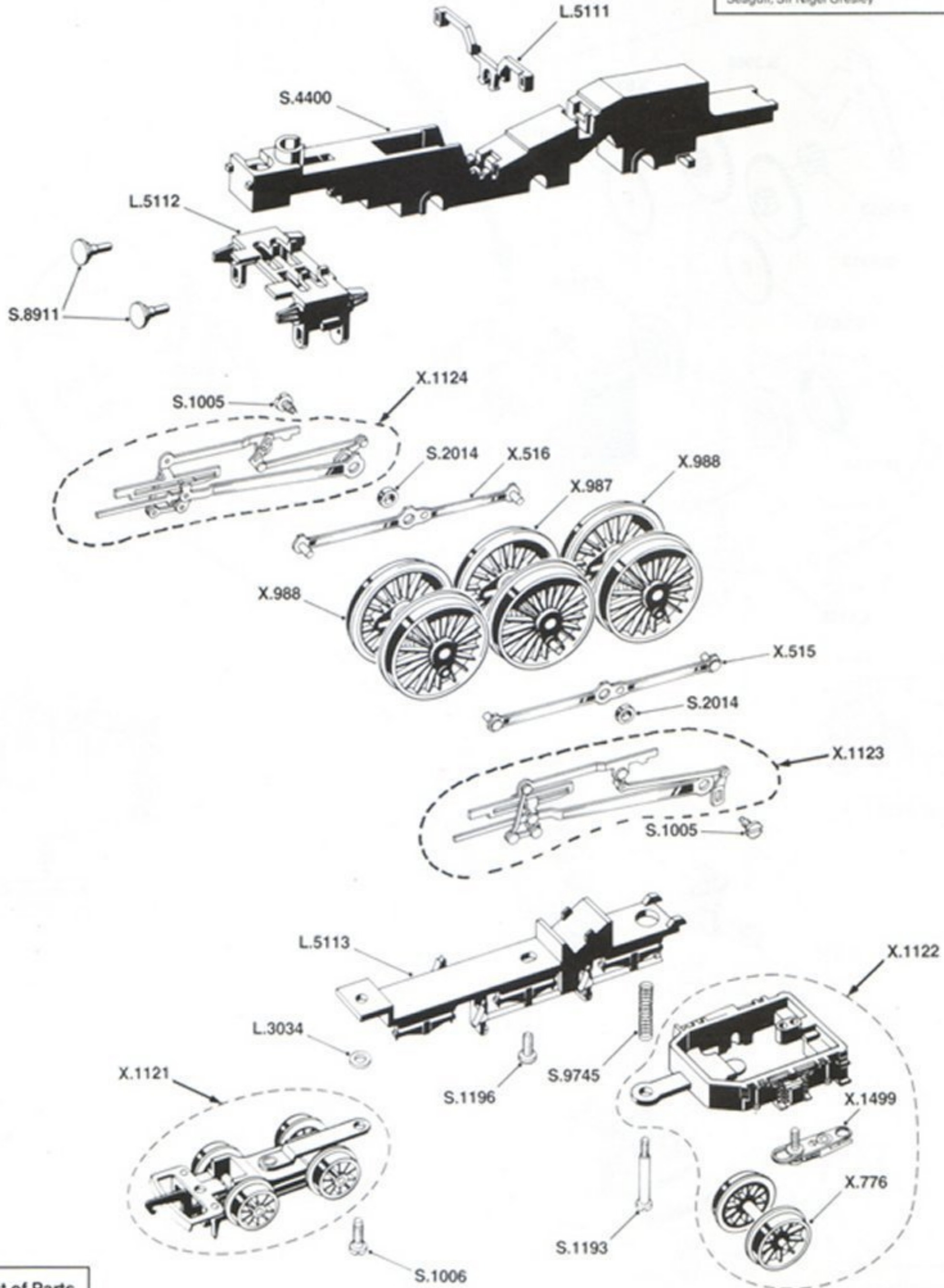

**List of Parts**

Ref. No.	Item	Ref. No.	Item	Ref. No.	Item
X.515	Coupling Rod L/H.....	X.1124	Valve Gear Assembly R/H.....	S.1005	Screw - Valve Gear.....
X.516	Coupling Rod R/H.....	X.1499	Close Coupling Assembly.....	S.1006	Screw - Bogie Fixing.....
X.776	Wheel/Axle Assembly.....	L.3034	Bogie Washer.....	S.1193	Screw - Pony Truck.....
X.987	Centre Driving Wheel/Axle Assy	L.5111	Motion Bracket.....	S.1196	Screw - Underframe.....
X.988	Driving Wheel/Axle Assembly...	L.5112	Cylinder Block.....	S.2014	Distance Piece.....
X.1121	Bogie Assembly.....	L.5113	Underframe.....	S.4400	Chassis.....
X.1122	Pony Truck Assembly.....			S.8911	Buffer - Round Head.....
X.1123	Valve Gear Assembly L/H.....			S.9745	Spring.....

**TENDER for LOCOMOTIVE CLASS A4**

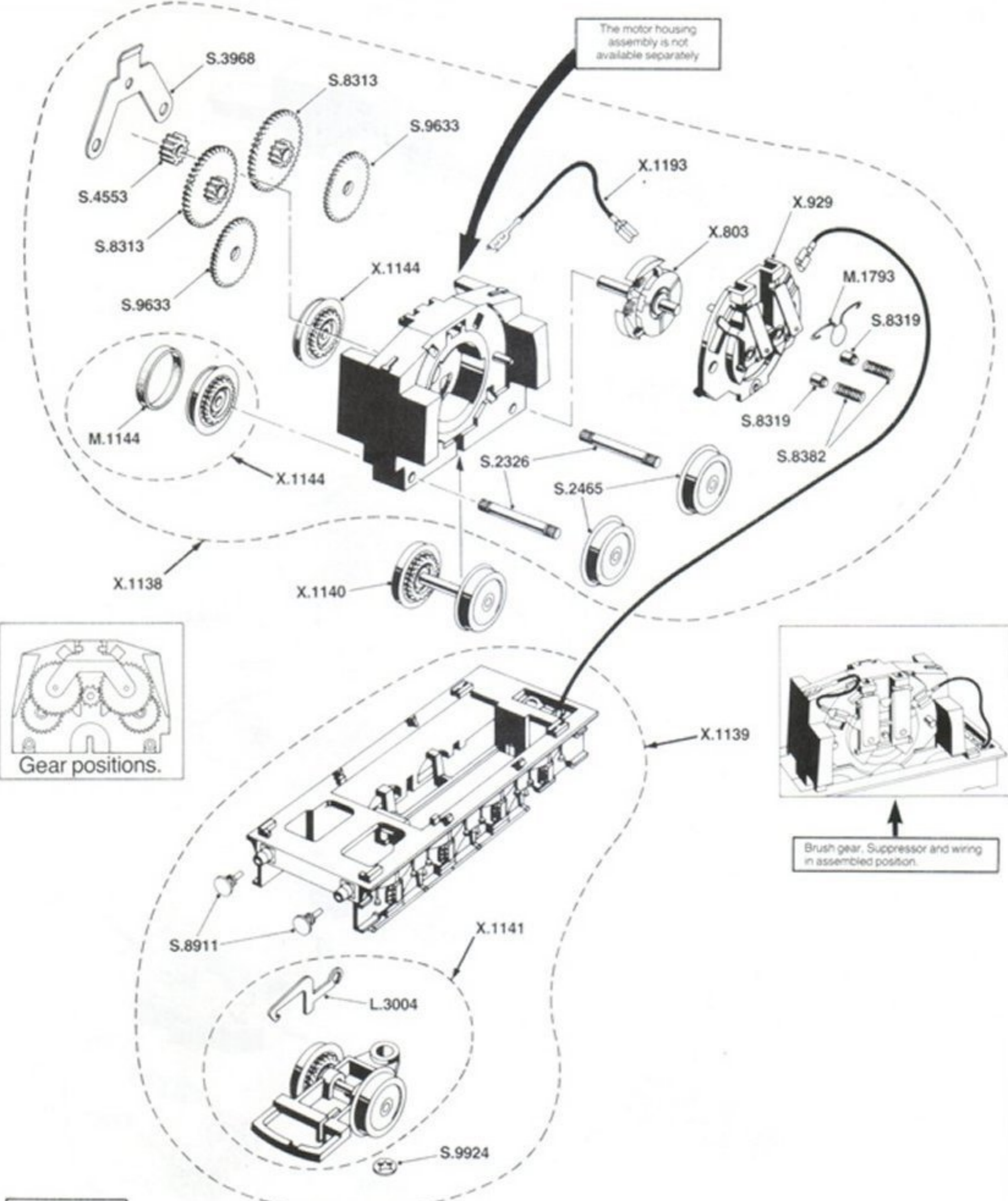

**List of Parts**

Ref. No.	Item	Ref. No.	Item	Ref. No.	Item
X.803	Armature/Commutator.....	L.3004	Coupling Hook.....	S.3968	Gear Retainer.....
X.929	Brush Retaining Arm Assy.....	M.1144	Traction Tyre.....	S.4553	Spur Gear - 11 Tooth.....
X.1138	Motor/Chassis Assembly.....	M.1793	Suppressor.....	S.8313	Spur Gear - 40/10 Tooth.....
X.1139	Chassis Frame Assembly.....			S.8319	Carbon Brush.....
X.1140	Centre Wheel/Axle Assembly...	S.2326	Axle.....	S.8319	Brush Spring.....
X.1141	Pony Truck Assembly.....	S.2465	Driving Wheel - Metal.....	S.8911	Buffer - Round Head.....
X.1144	Driving Wheel - Tyred.....			S.9633	Spur Gear - 33 Tooth.....
X.1193	Wire Lead Assembly.....			S.9924	Retaining Clip - Pony Truck.....