

**SHORT WHEELBASE TENDER DRIVE MOTOR**

Used with locomotive R.311 "Duke of Sutherland"  
Also suitable for use with R.357

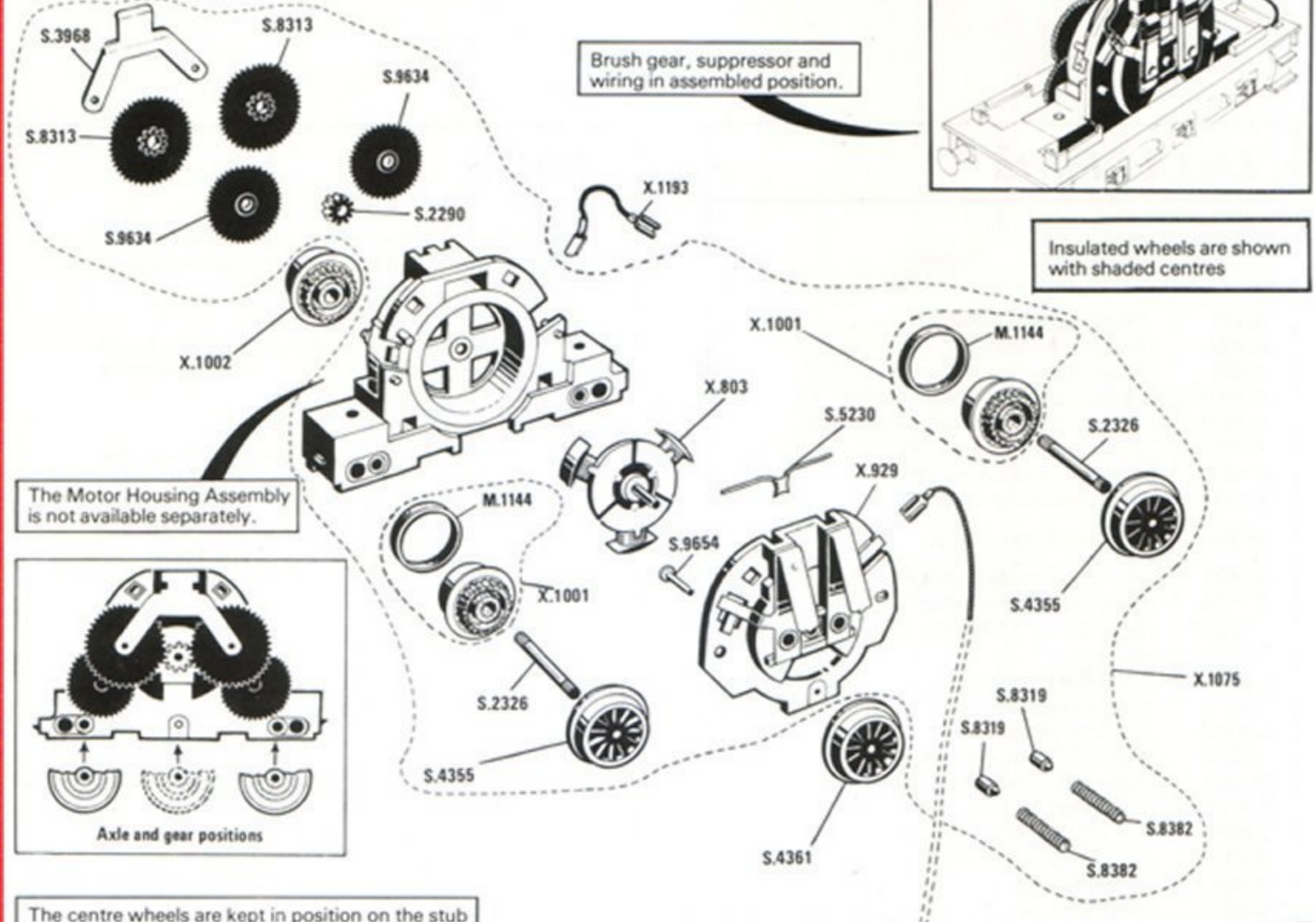

The centre wheels are kept in position on the stub axles by the tender underframe. Ensure that the insulated wheel (shaded centre) is on the correct side.

The coil springs (S.8382) provide contact pressure between the brushes (S.8319) and the commutator. The retaining arms must be adjusted so that the hooks hold the springs centrally in position but do not actually touch the back of the brushes. The correct pressure must be maintained when new brushes are fitted and it may be helpful to adjust the retaining arms by inserting a small screwdriver blade behind the centre of each arm and bending the bottoms slightly inwards.

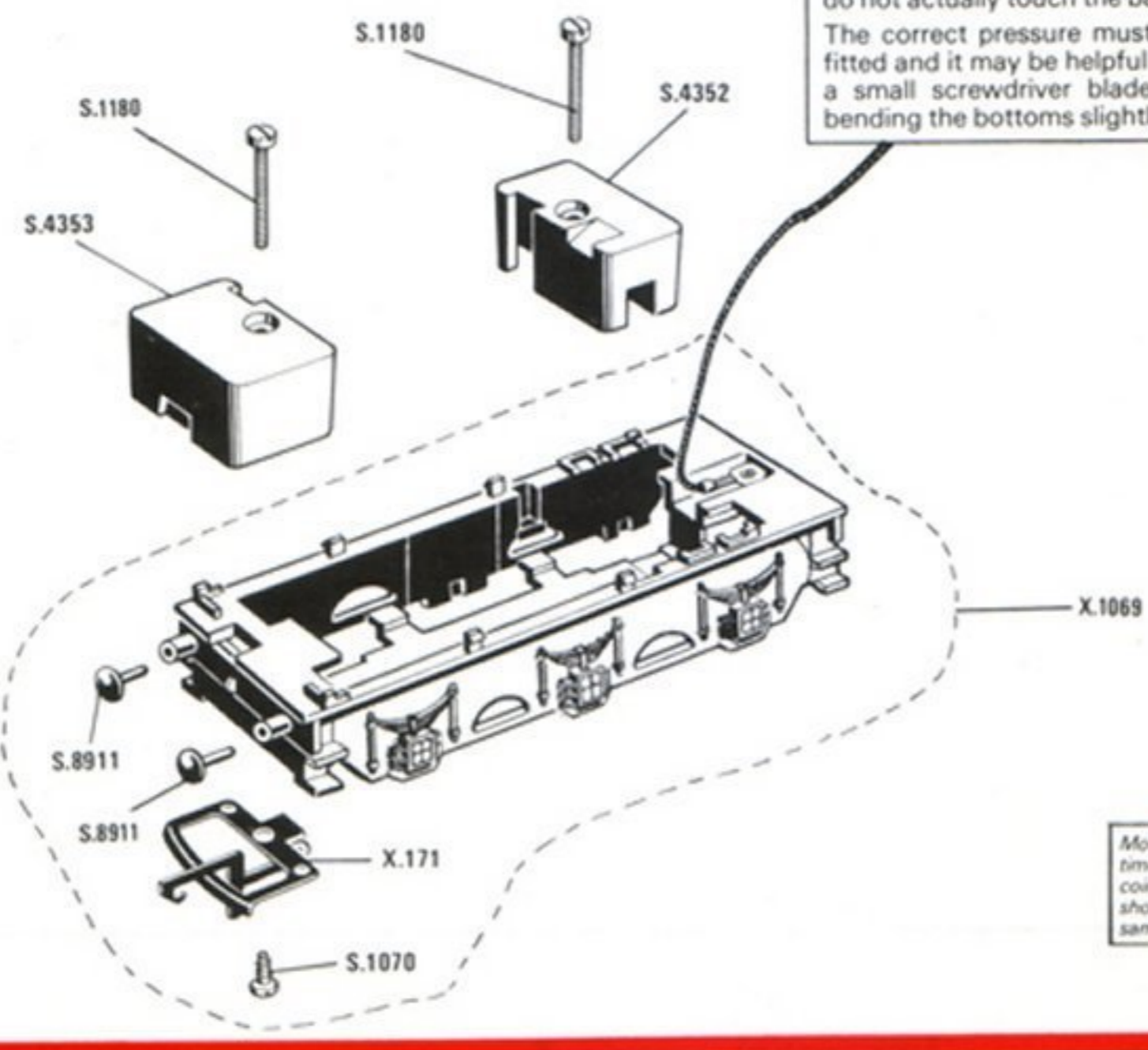

Modifications are made to models from time to time. If a spare part is required which does not coincide with the illustration, a full description should be given and, if necessary, a sketch or sample should accompany the order.

**HORNBY RAILWAYS**

**SHORT WHEELBASE TENDER DRIVE MOTOR**

Used with locomotive R.311 "Duke of Sutherland"  
Also suitable for use with R.357

List of Parts	
Ref. No.	Item
X.171	Coupling Unit Assembly
X.803	Armature Assembly
X.929	Brush Retaining Assembly
X.1001	Spoked Driving Wheel - Tyred
X.1002	Spoked Centre Wheel - Insulated
X.1069	Chassis Frame Assembly
X.1075	Motor/Chassis Assembly
X.1193	Wire Assembly - Motor
M.1144	Traction Tyre
S.1070	Screw - Coupling Unit Assembly
S.1180	Screw - Weight Fixing
S.2290	Spur Gear - 11 Tooth
S.2326	Axle
S.3968	Gear Retainer
S.4352	Weight - Front
S.4353	Weight - Rear
S.4355	Spoked Driving Wheel - All Metal
S.4361	Spoked Centre Wheel - All Metal
S.5230	Capacitor (Suppressor)
S.8313	Spur Gear - 40/10 Tooth
S.8319	Carbon Brush
S.8382	Brush Spring
S.8911	Buffer
S.9634	Spur Gear - 28 Tooth
S.9654	Stub Axle
<i>Items not illustrated</i>	
X.1401	Tender Body Complete

**Notes**

For lubricating instructions refer to the Hornby Locomotive Operation and Maintenance leaflet.

A reference diagram for fitting a Zero 1 Locomotive Module is included in the Locomotive Service Sheet, No. 119.

The Motor/Chassis Assembly (X.1075) clip-fits into the Chassis Frame Assembly (X.1069). When assembling insert the Locomotive end first. When dismantling use a small screwdriver blade to ease the Frame off the clip at the rear end.