

G.W.R. 4-4-0 COUNTY LOCOMOTIVE R.392

Powered by Tender Drive. See overleaf

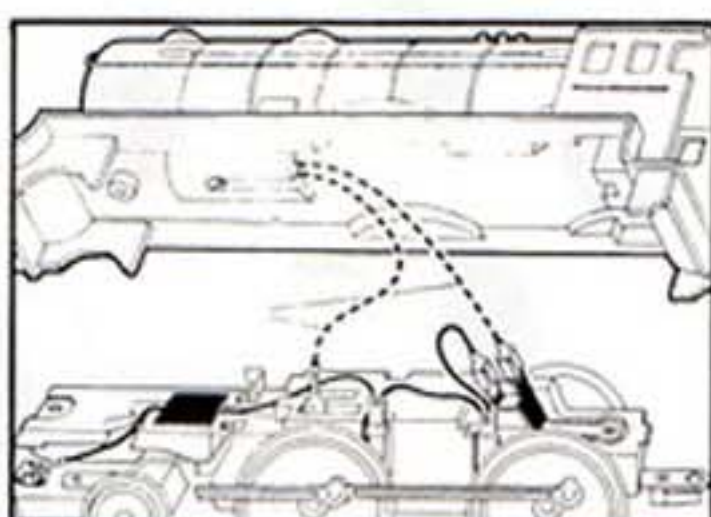
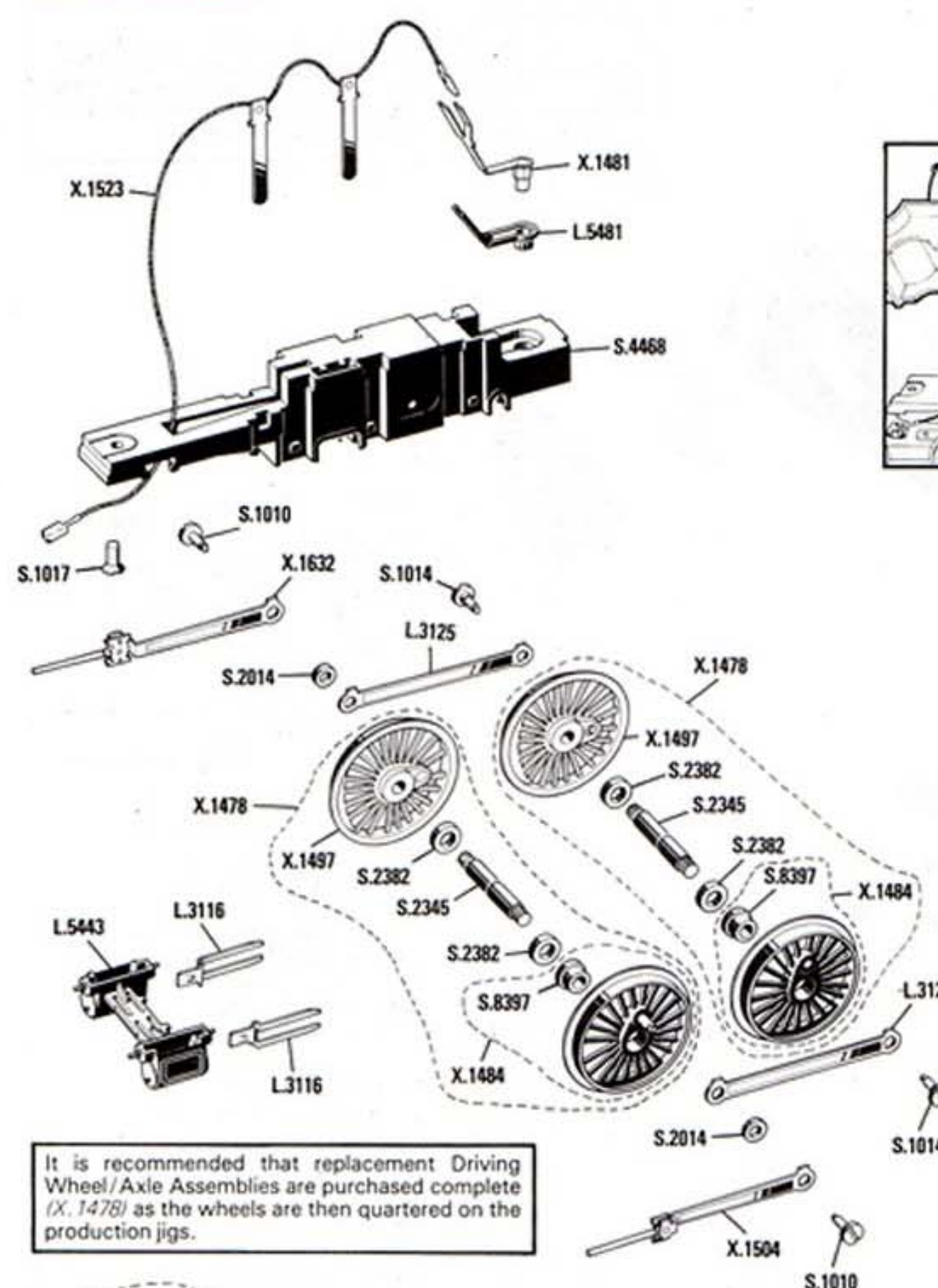

List of Parts	
Ref. No.	Item
X.737	Bogie Wheel—Insulated—R.H.
X.1478	Driving Wheel/Axle Assembly
X.1479	Drawbar Assembly
X.1481	Terminal Connector
X.1484	Driving Wheel—Bushed—L.H.
X.1497	Driving Wheel—Unbushed—R.H.
X.1502	Coupling Unit Assembly
X.1503	Bogie Assembly
X.1504	Crosshead Assembly—L.H.
X.1523	Wiring Harness/Collector Assembly ..
X.1632	Crosshead Assembly—R.H.
L.3004	Coupling Hook
L.3116	Crosshead Guide
L.3125	Coupling Rod
L.5434	Underframe
L.5442	Coupling Bar
L.5443	Cylinder Block
L.5481	Terminal Connector Seating
S.1010	Screw—Crosshead Assembly
S.1014	Screw—Coupling Rod
S.1017	Screw—Body Fixing
S.1070	Screw—Coupling Unit
S.2014	Distance Piece
S.2336	Axle—Bogie
S.2345	Axle—Driving Wheel
S.2382	Axle Bearing
S.4415	Bogie Wheel—All Metal—L.H.
S.4468	Chassis
S.8397	Insulating Bush
<i>Items not illustrated</i>	
R.521	Capsule Smoke Oil—5cc
X.1489	Smoke Unit Assembly
X.1501	Body Assembly Complete
S.2453	Standard Buffer
S.6390	Fireman
S.6391	Driver
S.8784	Vacuum Pipe

It is recommended that replacement Driving Wheel/Axle Assemblies are purchased complete (X.1478) as the wheels are then quartered on the production jigs.

The Chassis (S.4468) and Underframe (L.5434) clipfit together. To dismantle insert a small screwdriver blade at the rear end and ease underframe off clips. The bogie and driving wheel assemblies are held in position by the underframe.

Modifications are made to models from time to time. If a spare part is required which does not coincide with the illustration, a full description should be given and, if necessary, a sketch or sample should accompany the order.

R.393 TENDER FOR COUNTY LOCOMOTIVE

Smoke Unit. The tender drive unit will absorb most of the current when the locomotive/tender assembly is on 'live' track. If the locomotive is left on the track without its tender the Smoke Unit may receive excessive current, overheat and become damaged. If the Zero 1 System is in use the Smoke Unit, if properly connected, will not be affected by the permanent 18 volt A.C. track current, but Smoke Unit overheating may result if the locomotive's Module number is called up whilst the locomotive is standing on the track without its tender.

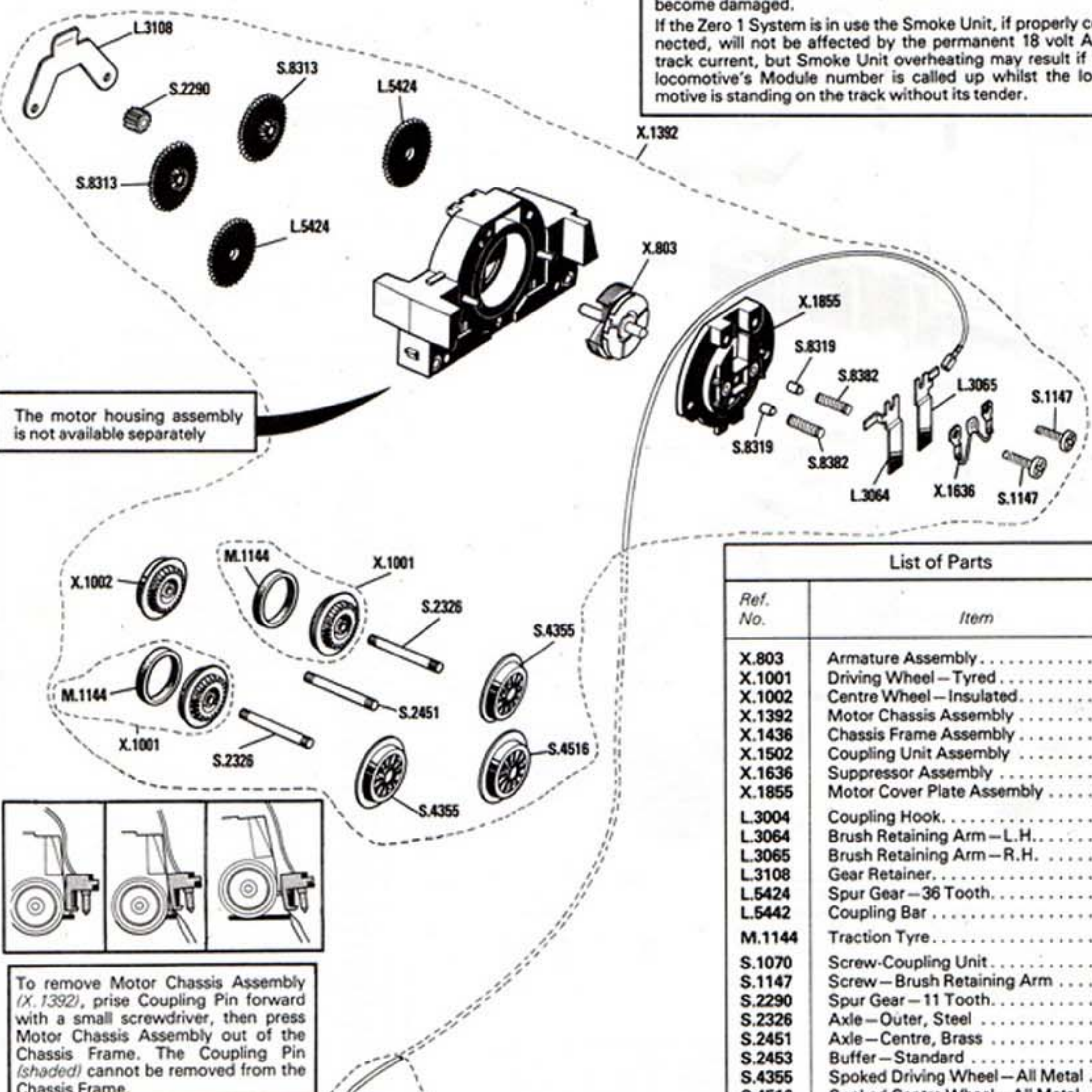

The motor housing assembly is not available separately

To remove Motor Chassis Assembly (X.1392), prise Coupling Pin forward with a small screwdriver, then press Motor Chassis Assembly out of the Chassis Frame. The Coupling Pin (shaded) cannot be removed from the Chassis Frame.

When Locomotive and Tender are coupled the contact pin on the Tender must be firmly pressed down so that it passes through the spring contact underneath the Locomotive Drawbar.

List of Parts	
Ref. No.	Item
X.803	Armature Assembly
X.1001	Driving Wheel—Tyred
X.1002	Centre Wheel—Insulated
X.1392	Motor Chassis Assembly
X.1436	Chassis Frame Assembly
X.1502	Coupling Unit Assembly
X.1636	Suppressor Assembly
X.1855	Motor Cover Plate Assembly
L.3004	Coupling Hook
L.3064	Brush Retaining Arm—L.H.
L.3065	Brush Retaining Arm—R.H.
L.3108	Gear Retainer
L.5424	Spur Gear—36 Tooth
L.5442	Coupling Bar
M.1144	Traction Tyre
S.1070	Screw—Coupling Unit
S.1147	Screw—Brush Retaining Arm
S.2290	Spur Gear—11 Tooth
S.2326	Axle—Outer, Steel
S.2451	Axle—Centre, Brass
S.2453	Buffer—Standard
S.4355	Spoked Driving Wheel—All Metal
S.4516	Spoked Centre Wheel—All Metal
S.8313	Spur Gear—40/10 Tooth
S.8319	Carbon Brush
S.8382	Brush Spring
S.8784	Vacuum Pipe
<i>Item not illustrated</i>	
X.1527	Tender Body Assembly