

CLASS 142 PACER TWIN RAILBUS

With 4 wheel pick-up as manufactured from September 1989

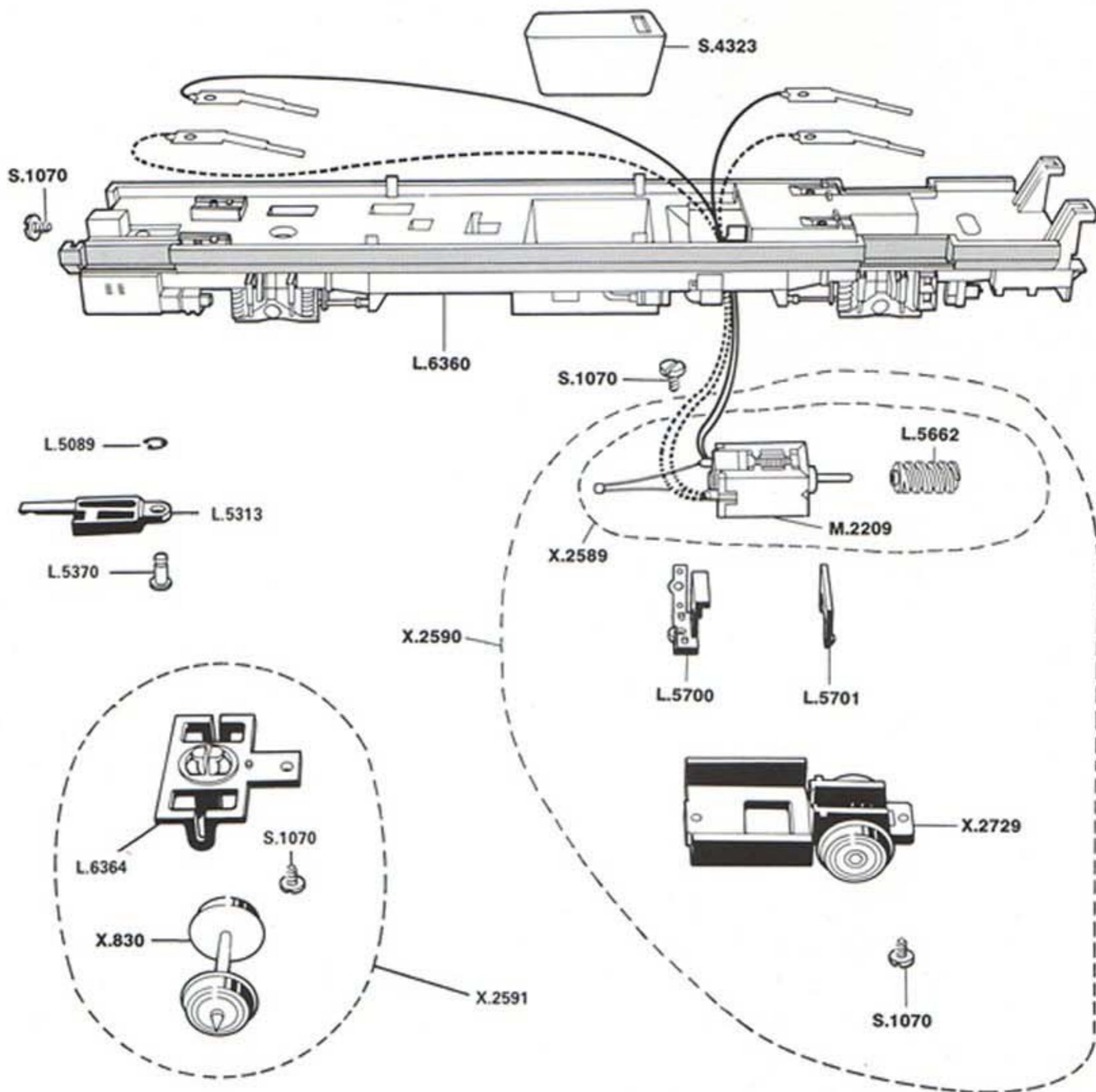

List of Parts

Ref. No.	Item	Ref. No.	Item
X.830	Wheel Assembly.....	L.5662	Worm Gear.....
X.2589	Motor with Harness.....	L.5700	Motor Retainer—Rear.....
X.2590	Power Bogie.....	L.5701	Motor Retainer—Front.....
X.2591	Pivot Bogie.....	L.6360	Chassis.....
X.2729	Motor Frame Assembly.....	L.6364	Pivot Bogie Frame.....
L.5089	Retaining Clip.....	M.2209	Motor only.....
L.5313	Coupling.....	S.1070	Screw.....
L.5370	Pivot Pin.....	S.4323	Weight.....