

X.1436 TENDER MECHANISM for GWR 2-8-0 LOCOMOTIVE

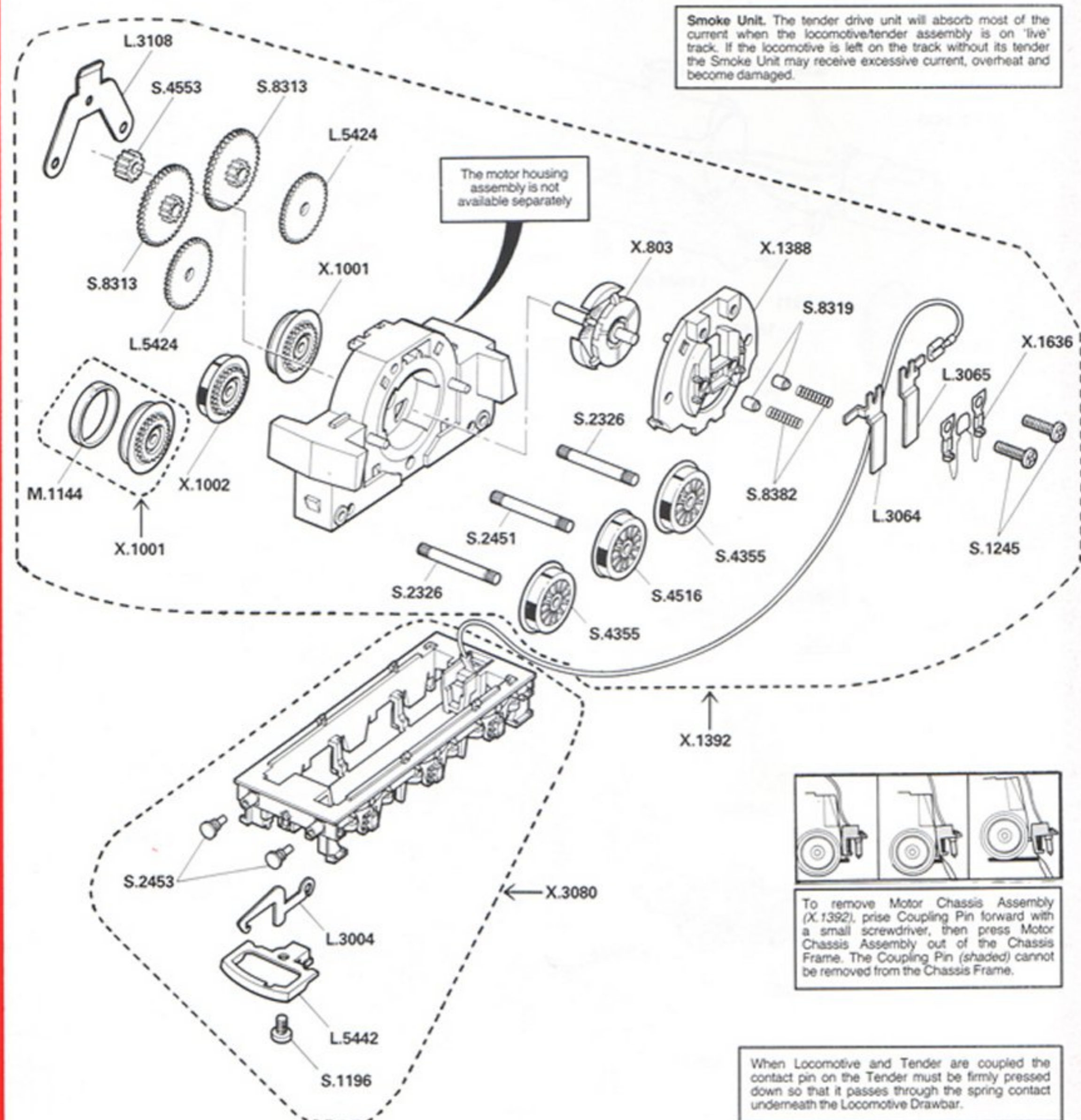

List of Parts

X.803	Armature/Commutator	M.1144	Traction Tyre
X.1001	Driving Wheel — Tyred	S.1196	Screw — Coupling
X.1002	Centre Wheel — Insulated	S.1245	Screw — Brushgear
X.1388	Cover Plate Assembly	S.2326	Axle — Outer, Steel
X.1392	Motor/Chassis Assembly	S.2451	Axle — Centre, Brass
X.1436	Complete Tender Mechanism	S.2453	Buffer
X.1636	Capacitor Assembly	S.4355	Driving Wheel — Metal
X.3080	Tender Chassis Assembly	S.4516	Centre Wheel — Metal
L.3004	Coupling Hook	S.4553	Spur Gear — 11 Tooth
L.3064	L/H Brush Retaining Arm	S.8313	Spur Gear — 40/10 Tooth
L.3065	R/H Brush Retaining Arm	S.8319	Carbon Brush
L.3108	Gear Retainer	S.8382	Brush Spring
L.5424	Spur Gear — 36 Tooth		
L.5442	Coupling Bar		

SERVICE SHEET No. 155

HORNBY HOBBIES

A4 — Printed in England

See overleaf for Tender

GWR 2-8-0 LOCOMOTIVE

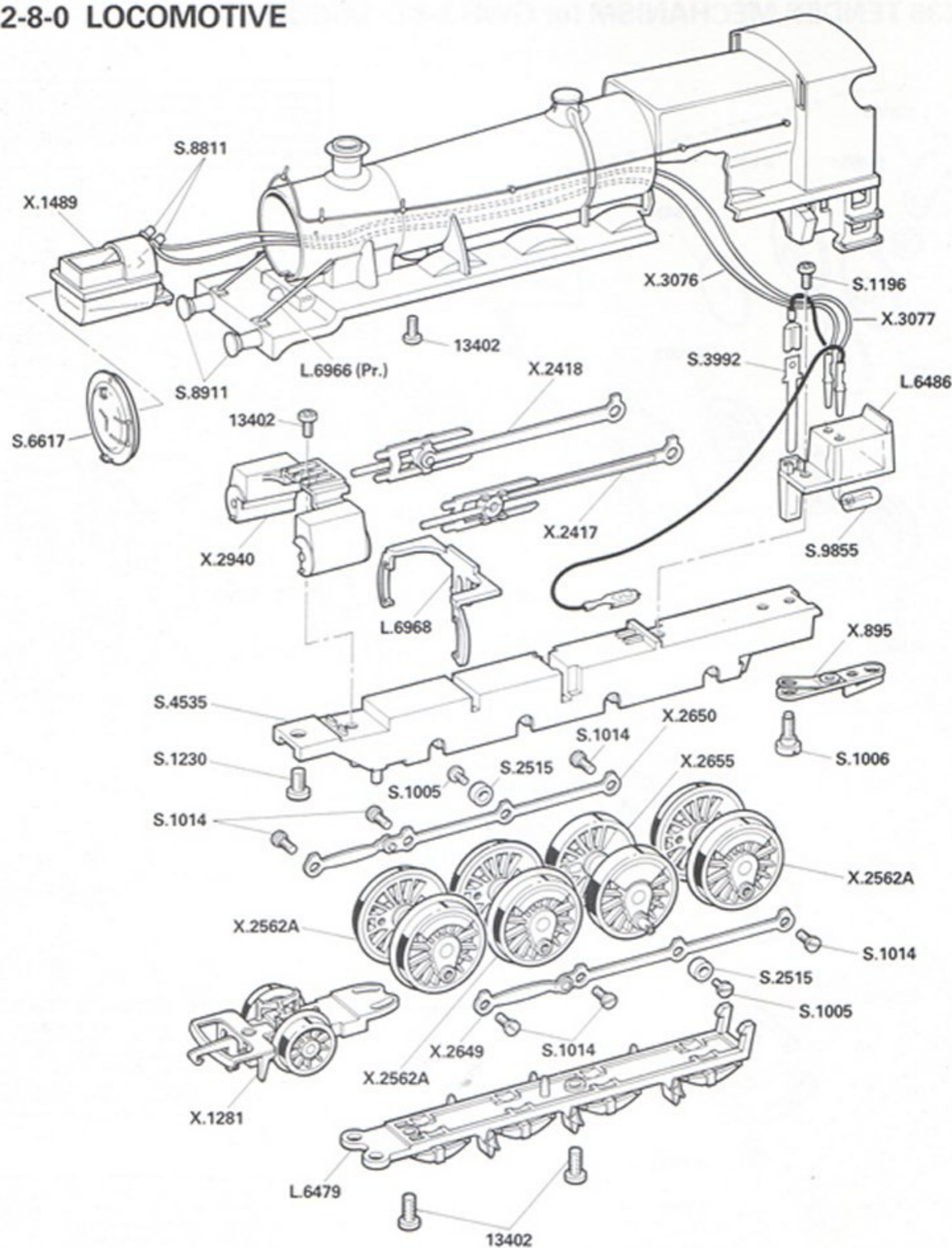

List of Parts

X.895	Drawbar Assembly	M.2485	Oil Filling Pipette
X.1281	Pony Truck	S.1005	Screw — Connecting Rod
X.1489	Smoke Unit	S.1006	Screw — Drawbar
X.2417	L/H Crosshead Assembly	S.1014	Screw — Coupling Rod
X.2418	R/H Crosshead Assembly	S.1196	Screw — Light Box
X.2562A	Drive Wheel/Axle Assembly	S.1230	Screw — Body Fixing
X.2649	L/H Coupling Rod	S.2515	Distance Piece
X.2650	R/H Coupling Rod	S.2515	Collector
X.2655	Drive Wheel/Axle Assembly	S.4535	Chassis Casting
X.2940	Cylinder Block	S.6617	Smokebox Door
X.3076	Wiring Harness A	S.8811	Eyelet
X.3077	Wiring Harness B	S.8911	Buffer
L.6479	Underframe	S.9855	Bulb
L.6486	Light Box		
L.6966	Stays (Pair)		
L.6968	Motion Bracket	13402	Screw

Smoke Generator

- To obtain access to the generator:
1. Remove loco body from chassis by undoing screw S.1230 accessible through square hole in front pony truck frame.
 2. Ease out the front five handrail members to lift handrail clear of smoke box door. Remove this by prising out from its bottom edge with a small screwdriver.
 3. Undo screw 13402 which will then enable the generator to be pulled out from the front.
- To refit Smoke Generator in boiler, slide in from the front. The small lug at the rear of the generator locates in the rectangular slot adjacent to the fixing screw hole. When the generator is correctly positioned for screwing in, hold it in place by inserting a wedge through the front. When it is screwed in, check from the front that it is lying centrally in the boiler.