

4-4-0 LOCOMOTIVE "HUNT" CLASS D49/2

The Bogie and Driving Wheel Assemblies are held in position by the Chassis Top and Bottom Sections (S.4468 & L.5434).

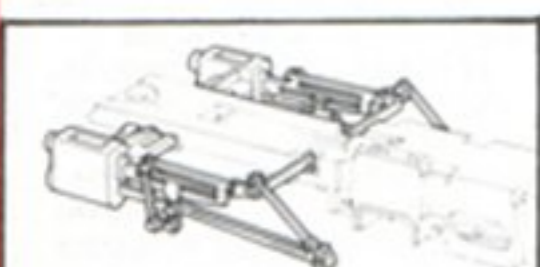

View showing Cylinder Block (N.1678) and Valve Gear (X.1474/5) in position on Chassis Top Section (S.4468).

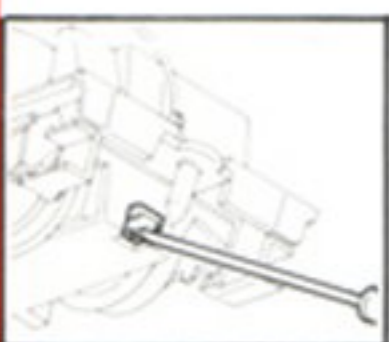

The Chassis Top and Bottom Sections (S.4468 & L.5434) clip-fit together. To dismantle insert a small screwdriver at the rear end and gently ease underframe off clips.

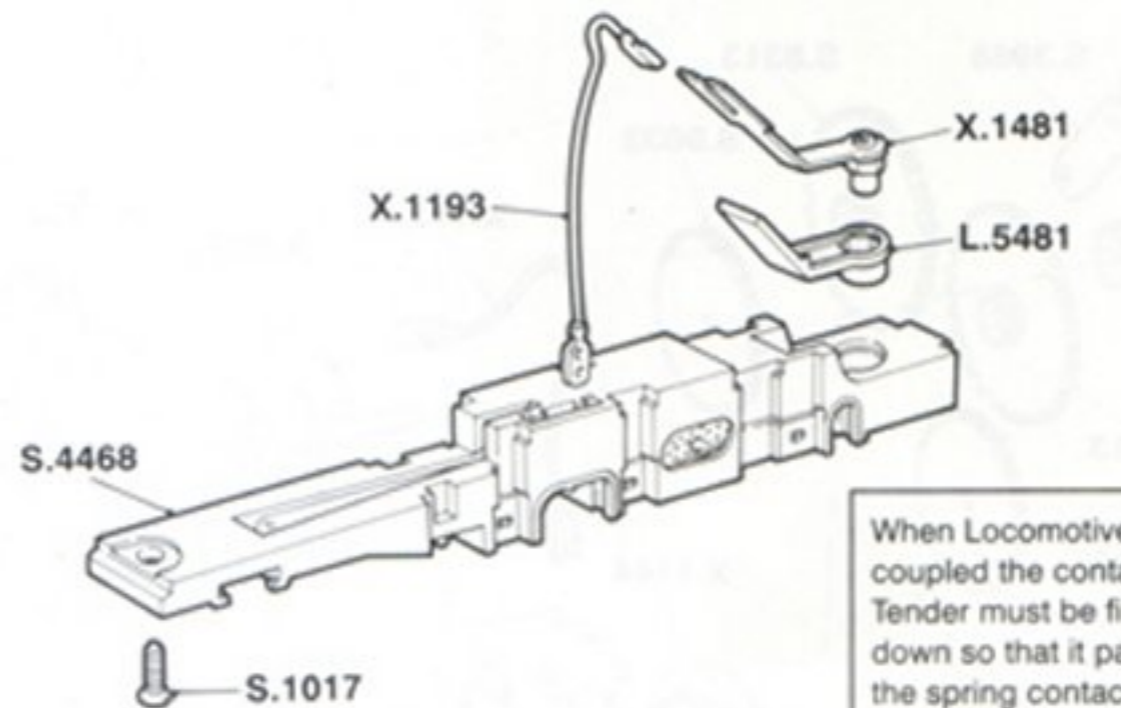
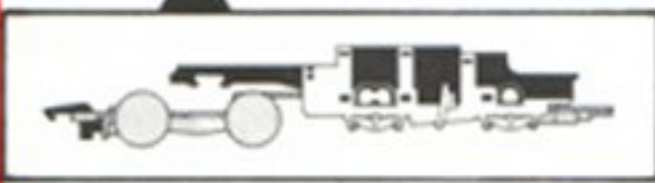

When Locomotive and Tender are coupled the contact pin on the Tender must be firmly pressed down so that it passes through the spring contact underneath the Locomotive Drawbar.

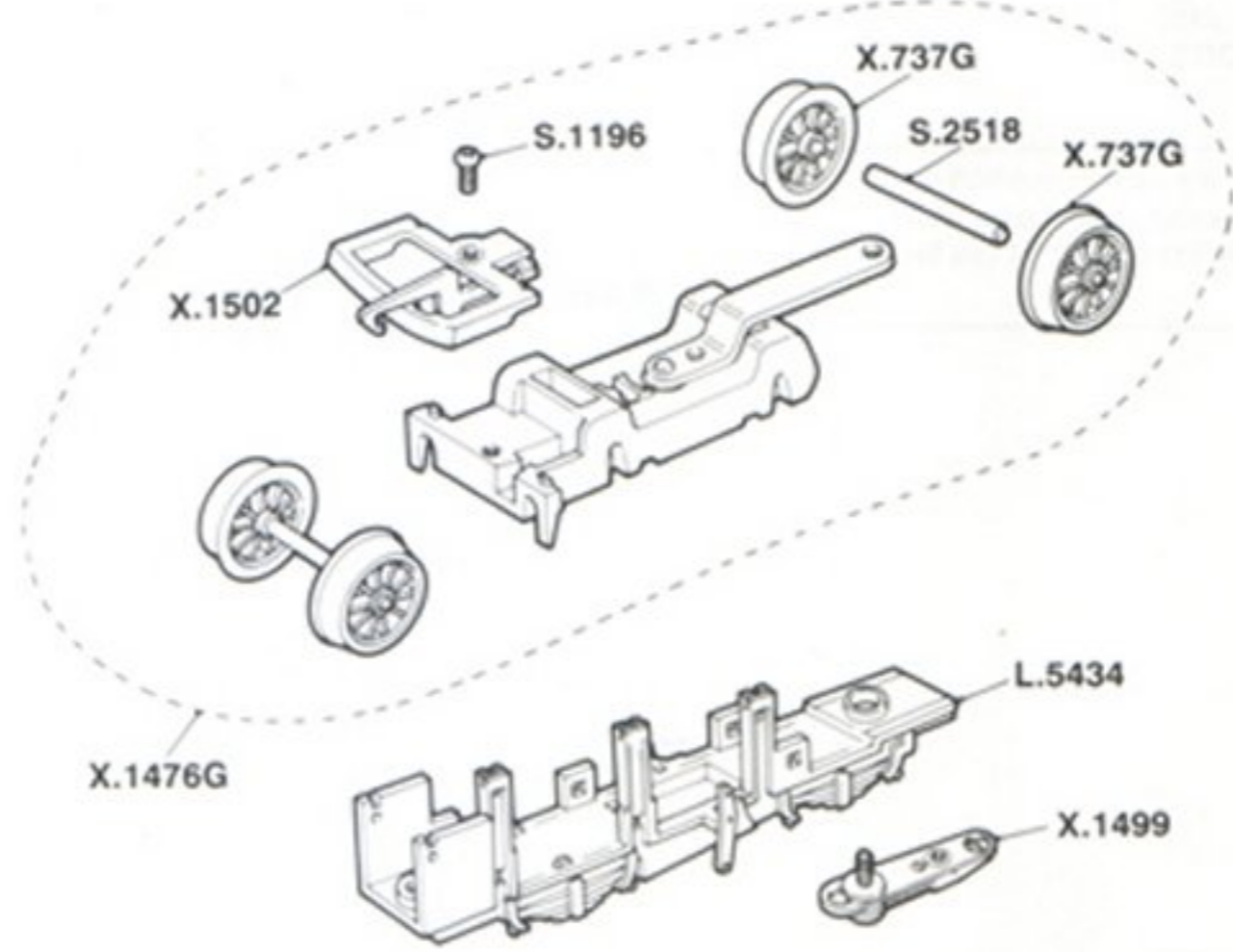
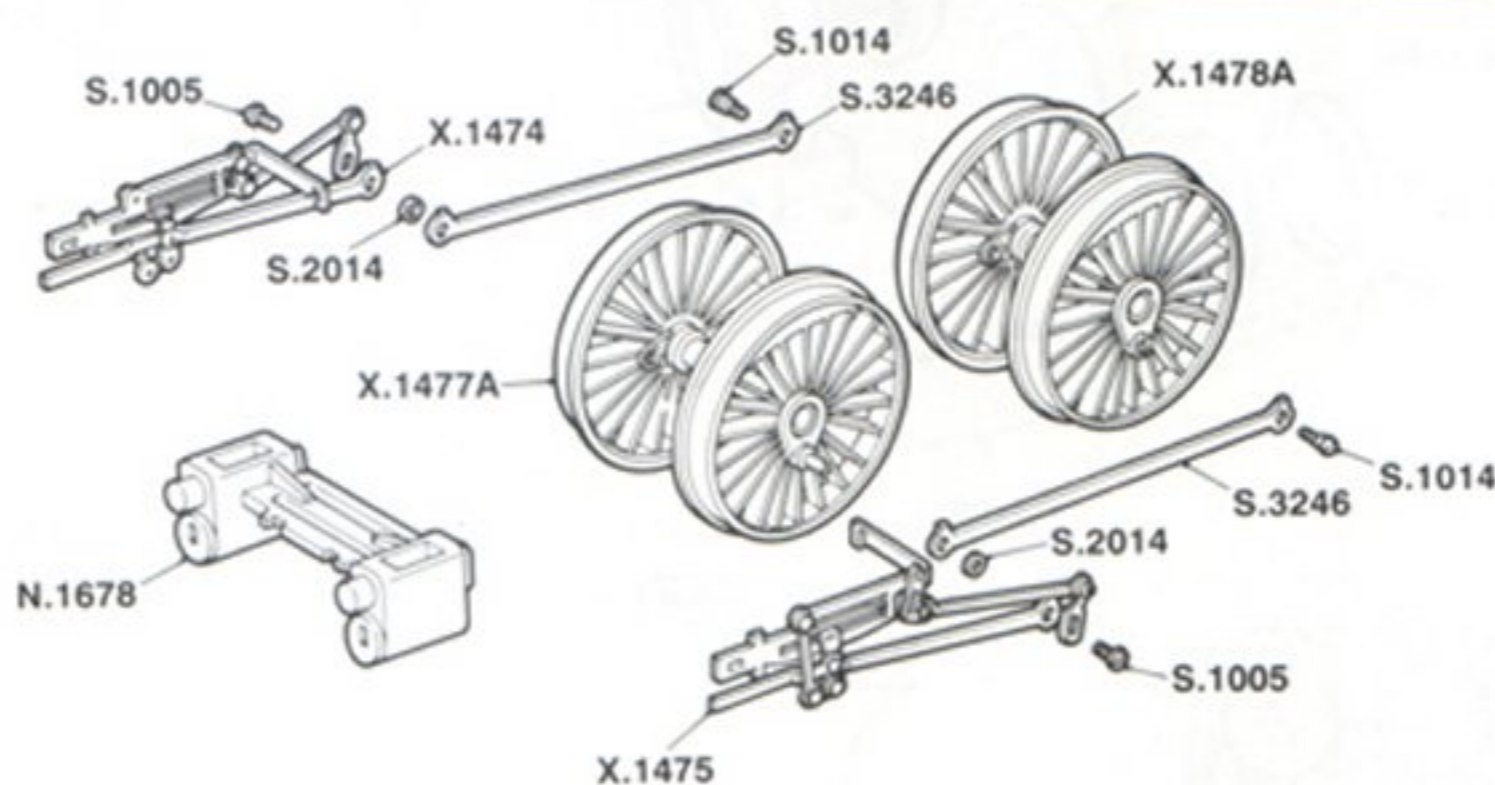

List of Parts

Ref. No.	Item	Ref. No.	Item	Ref. No.	Item
X.737G	Wheel Assembly - Bogie	X.1499	Drawbar Assembly	S.1196	Screw - Coupling Unit Assembly
X.1193	Wire Lead Assembly	X.1502	Coupling Unit Assembly	S.2014	Distance Piece
X.1474	Valve Gear Assembly - R.H.	L.5434	Chassis - Bottom Section	S.2518	Axle - Bogie
X.1475	Valve Gear Assembly - L.H.	L.5481	Terminal Connector Seating ...	S.3246	Coupling Rod
X.1476G	Bogie Assembly Complete	N.1678	Cylinder Block	S.4468	Chassis - Top Section
X.1477A	Driving Wheel / Axle Assembly - Front	S.1005	Screw - Valve Gear	Not Illustrated	
X.1478A	Driving Wheel / Axle Assembly - Rear	S.1014	Screw - Coupling Rod	S.2345	Axle - Driving Wheel
X.1481	Terminal Connector	S.1017	Screw - Body Fixing	S.2382	Axle Bearing
				S.8397	Insulating Bush

TENDER DRIVE FOR 4-4-0 LOCOMOTIVE "HUNT" CLASS

Brush gear and suppressor in assembled positions.

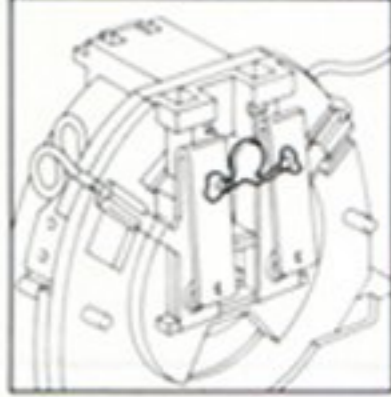

The brush springs (S.8382) provide contact pressure between the brushes (S.8319) and the commutator. The retaining arms must be adjusted so that the hooks hold the springs centrally in position but do not actually touch the back of the brushes. The correct pressure must be maintained when new brushes are fitted and it may be helpful to adjust the retaining arms by inserting a small screwdriver blade behind the centre of each arm and bending the bottoms slightly inwards.

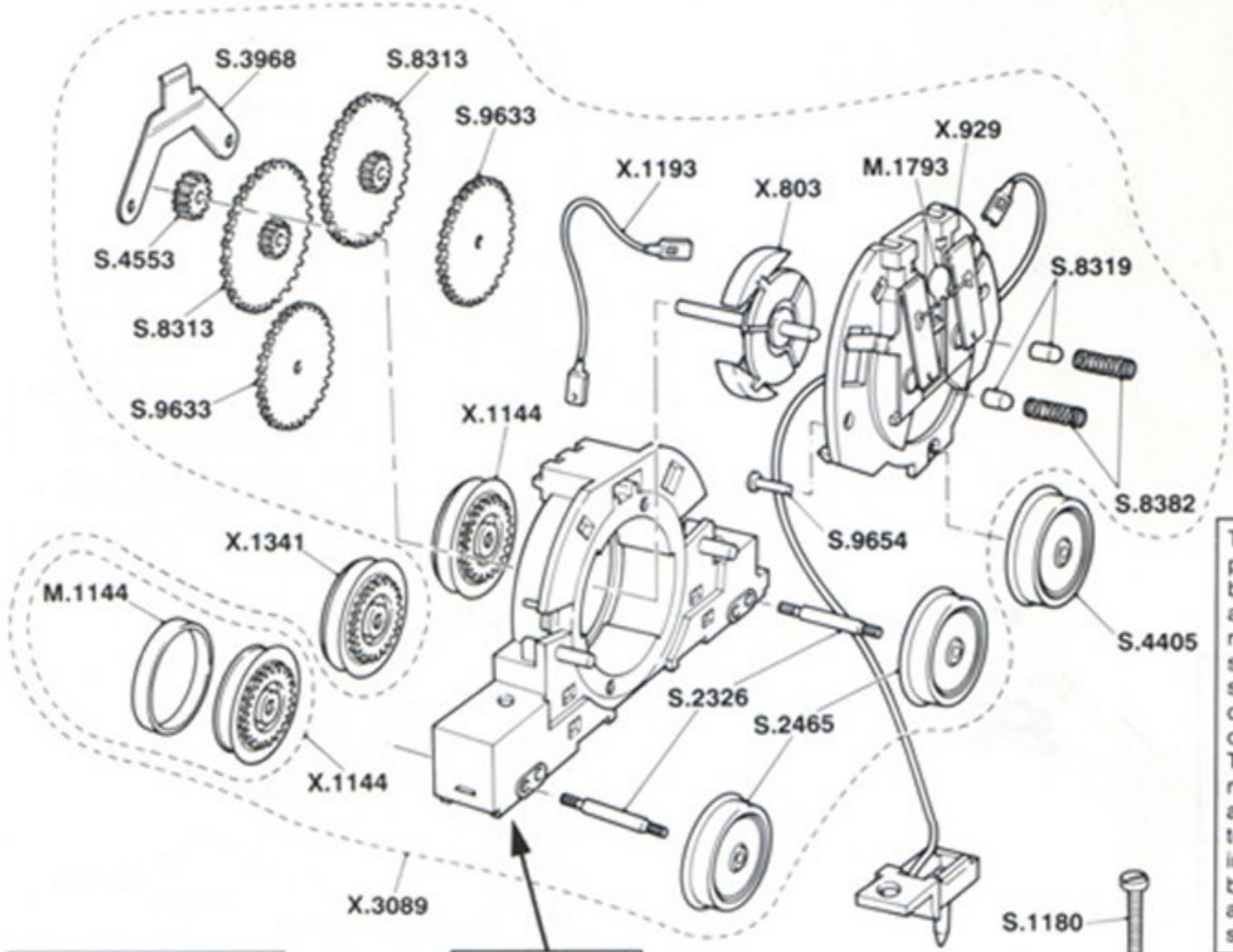

The motor housing assembly is not available separately.



The centre wheels are kept in position on the stub axles by the tender underframe. ENSURE THAT THE INSULATED WHEEL IS ON THE CORRECT SIDE.

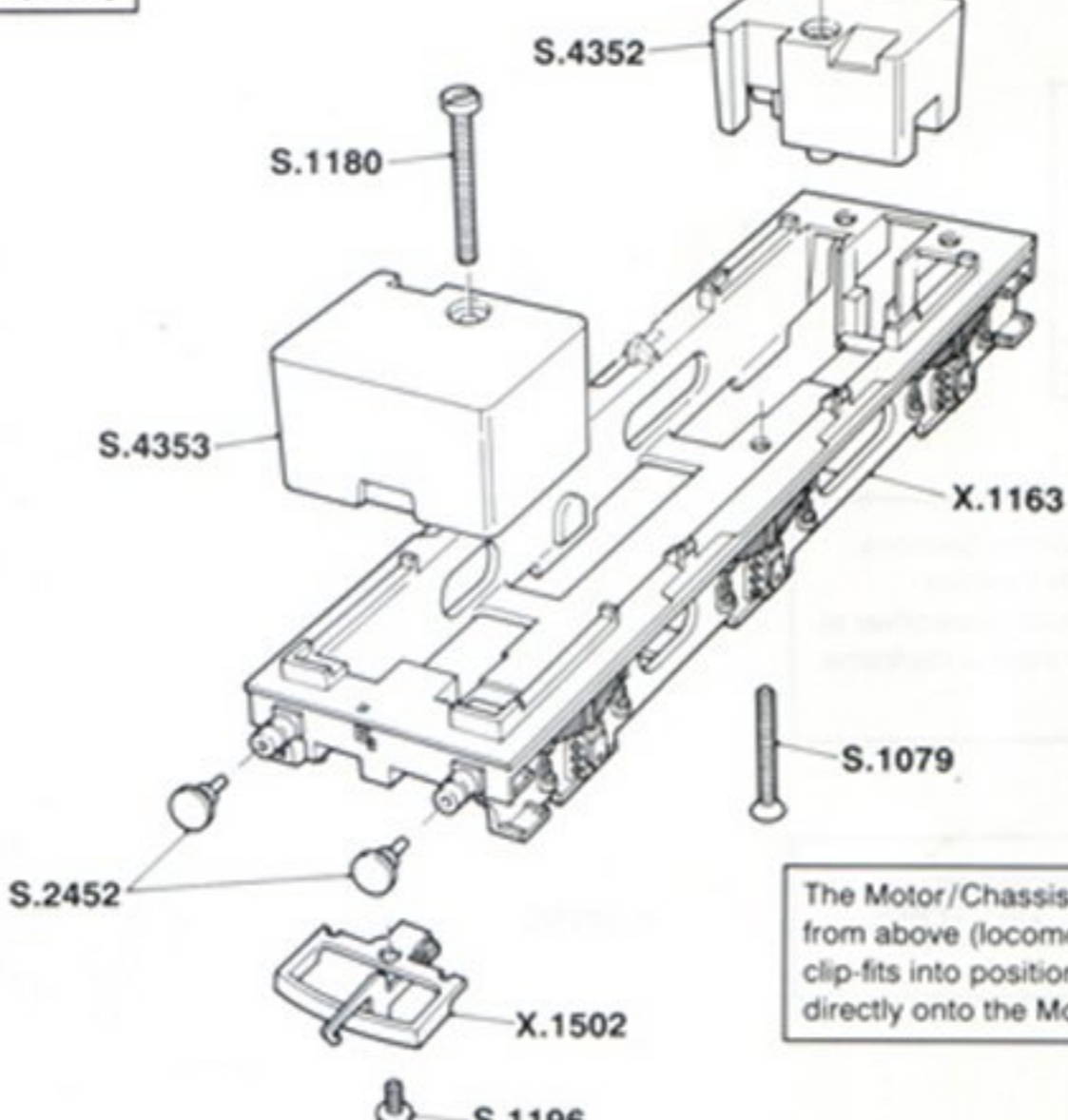

The Motor/Chassis Assembly is inserted from above (locomotive end first) and clip-fits into position. The Weights fix directly onto the Motor/Chassis Assembly.

List of Parts

Ref. No.	Item	Ref. No.	Item	Ref. No.	Item
X.803	Armature Assembly	M.1144	Traction Tyre	S.4352	Weight - Front
X.929	Brush Retaining Arm Assembly ..	M.1793	Suppressor	S.4353	Weight - Rear
X.1144	Driving Wheel - Tyred	S.1079	Screw - Motor/Chassis Fixing	S.4405	Centre Wheel - Metal
X.1163	Tender Chassis Assembly	S.1180	Screw - Weight Fixing	S.4553	Spur Gear - 11 Tooth
X.1193	Wire Lead Assembly	S.1196	Screw - Coupling Unit Assembly ..	S.8313	Spur Gear - 40/10 Tooth
X.1341	Driving Wheel - Centre	S.2326	Axle	S.8319	Carbon Brush
X.1502	Coupling Unit Assembly	S.2452	Buffer - Round Head	S.8382	Brush Spring
X.3089	Motor Chassis Assembly	S.2465	Driving Wheel - Metal	S.9633	Spur Gear - 33 Tooth
		S.3968	Gear Retainer	S.9654	Stub Axle